



Provost Estate, N1

£375,000

A bright, one bedroom apartment located on the fourth floor. This property offers a separate kitchen and reception room, wooden flooring throughout, and a private balcony.

Situated equidistance from Shoreditch Park and Old Street tube station, this location is ideal for those that want easy access to green space but also require the practicality of fantastic transport links.

Features

- Private Balcony
- Wooden Flooring
- Separate Kitchen
- Good Transport Links
- Fourth Floor
- City Views

Provost Estate, London, N1

Fourth Floor

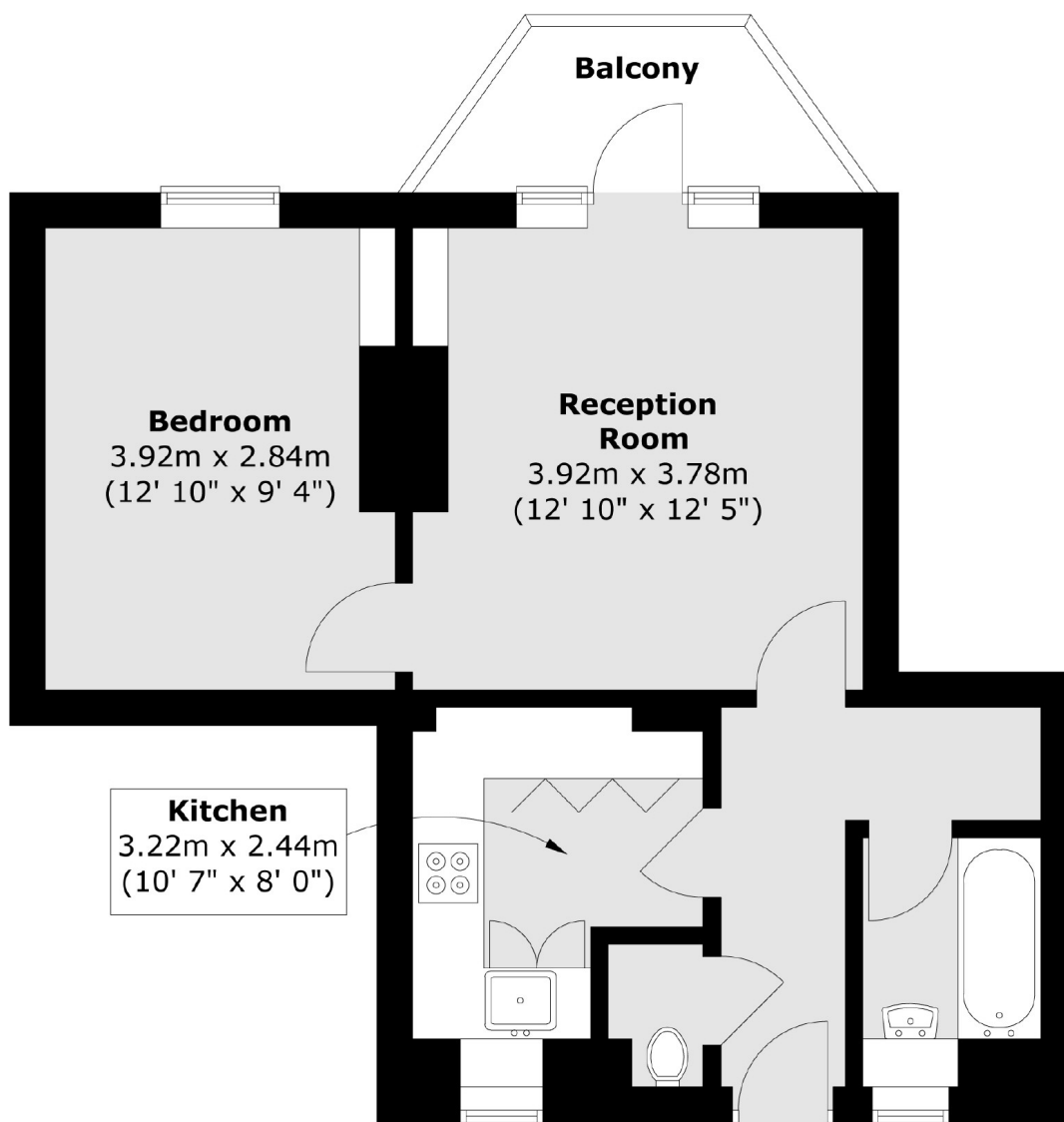

Total area (approx.) : 44.8 sq. m (482 sq. ft)
Total balcony area (approx.) : 3.9 sq. m (42 sq. ft)