



Commercial Road, E1

£660,000

This two-bedroom apartment is located on the second floor and comprises a semi-open plan, fully equipped, contemporary kitchen, living and dining area, two double bedrooms, modern family bathroom and a spacious winter garden. The apartment comes complete with plenty of built-in storage. Aldgate Place benefits from landscaped gardens, 24-hour concierge, a fully equipped resident's gym and secure underground bicycle storage.

Conveniently located within walking distance to the City, Spitalfields Market, Tower Bridge and Shoreditch. Close to an array of shopping, restaurants, bars and entertainment within easy reach. Located near four zone one underground stations (Aldgate, Aldgate East, Tower Hill, Liverpool St.) within walking distance, DLR in Tower Gateway and Liverpool Street and Fenchurch Street Rail all easily accessible.

Features

- Floor to Ceiling Windows
- Resident Gym
- 24-Hour Concierge
- Secure Bicycle Storage
- Fantastic Transport Links
- OIEO £700,000

Commercial Road, London, E1

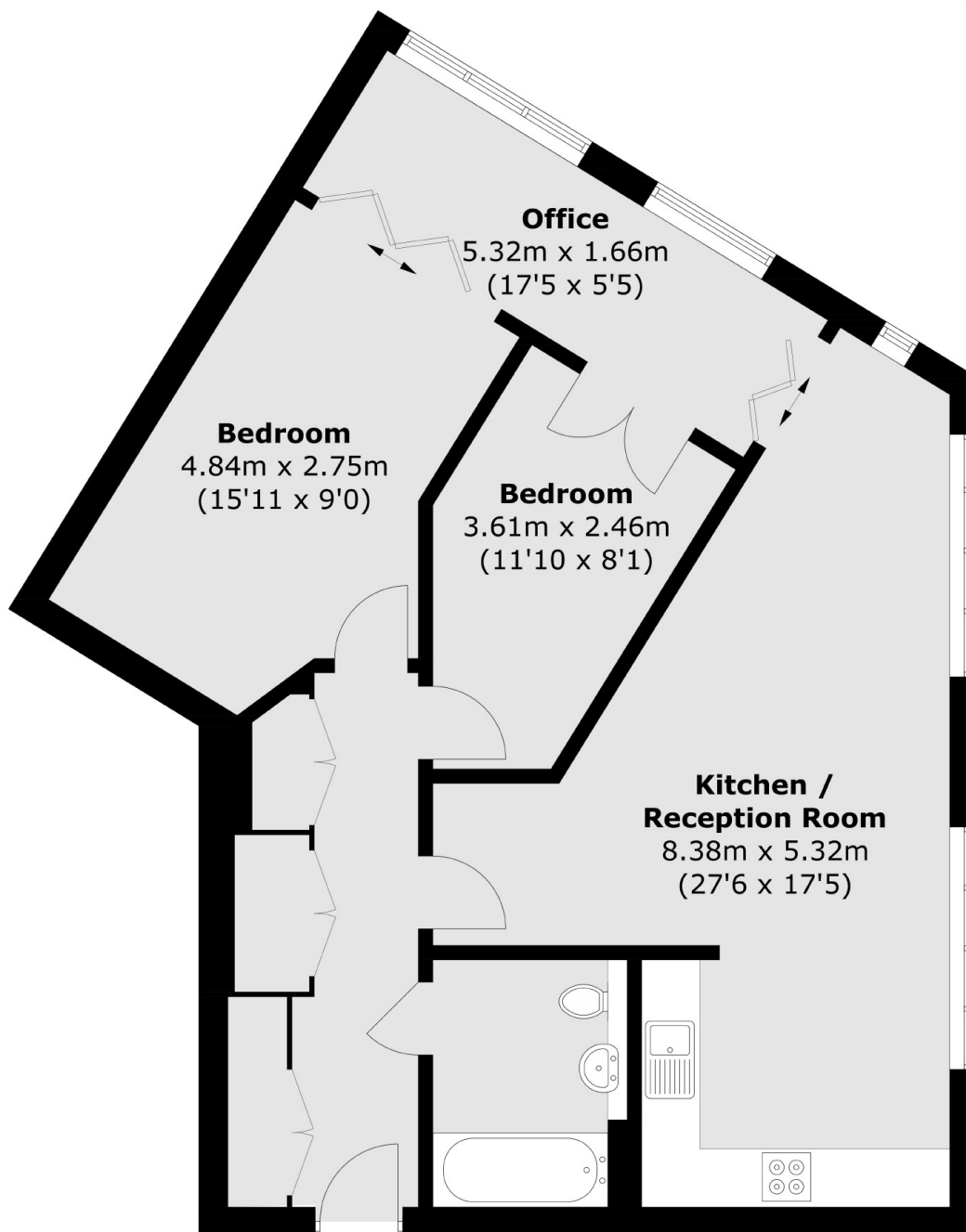

Total area (approx.): 80.1 sq. m (862.2 sq. ft)

Dexters

Shoreditch
44 Great Eastern Street
London
EC2A 3EP
Sales
0207 483 6371

Energy Rating: B. We aim to make our particulars both accurate and reliable. However they are not guaranteed; nor do they form part of an offer or contract. If you require clarification on any points then please contact us, especially if you're traveling some distance to view. Please note that appliances and heating systems have not been tested and therefore no warranties can be given as to their good working order.

 **RICS** | Regulated
Estate Agent
and Letting Agent

dexters.co.uk