



## Candle Street, E1

£450,000

A two double bedroom lateral apartment located on the second floor of this purpose built block. This property is located canal side and has a Juliet balcony. The apartment offers open plan living with a fully fitted kitchen, two double bedrooms, one with en suite, and one family bathroom. The property also benefits from dedicated utility, storage and cupboard space. There is also off street parking, available to rent.

Johnson Lock Court is equidistant between Mile End and Limehouse stations under a half mile away. At the end of the road is Mile End Park, Stadium and the Regents Canal. Limehouse Marina and the banks of River Thames are within a close proximity with all their cafes, pubs and restaurants.

### Features

- Open Plan
- Two Double Bedrooms
- Purpose Built
- En Suite
- Off Street Parking Available
- Canal Side

# Candle Street, London, E1

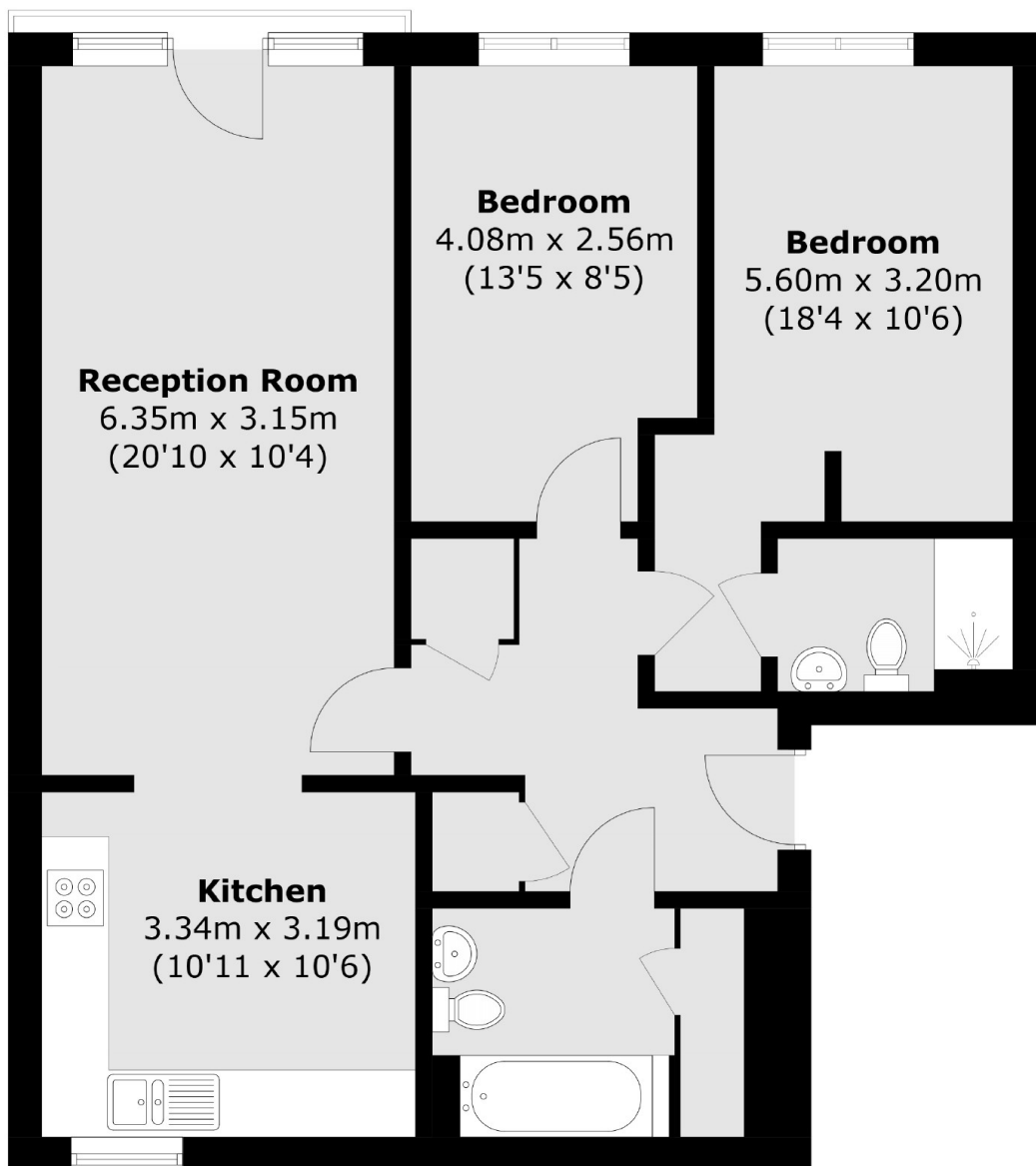

Total area (approx.): 74.5 sq. m (801.9 sq. ft)