



## Long Street, E2

### £500,000

A two bedroom apartment with generous living space. The property benefits a contemporary built-in modern kitchen with a Bosch washer/dryer and Miele Appliances along with built-in air conditioning throughout. Residents have access to a 24 Hour concierge, private library, resident gym, spa, communal outdoor spaces, and cinema room.

Within walking distance from major transport hubs such as Liverpool Street station, home to Cross rail with direct lines to Heathrow Airport, Central Line, Hammersmith and City and national rail services.

### Features

- Air Conditioning
- Gated Community
- Residents Facilities
- Two Double Bedrooms
- Close to Transport Link
- Bicycle Storage

# Long Street, London, E2

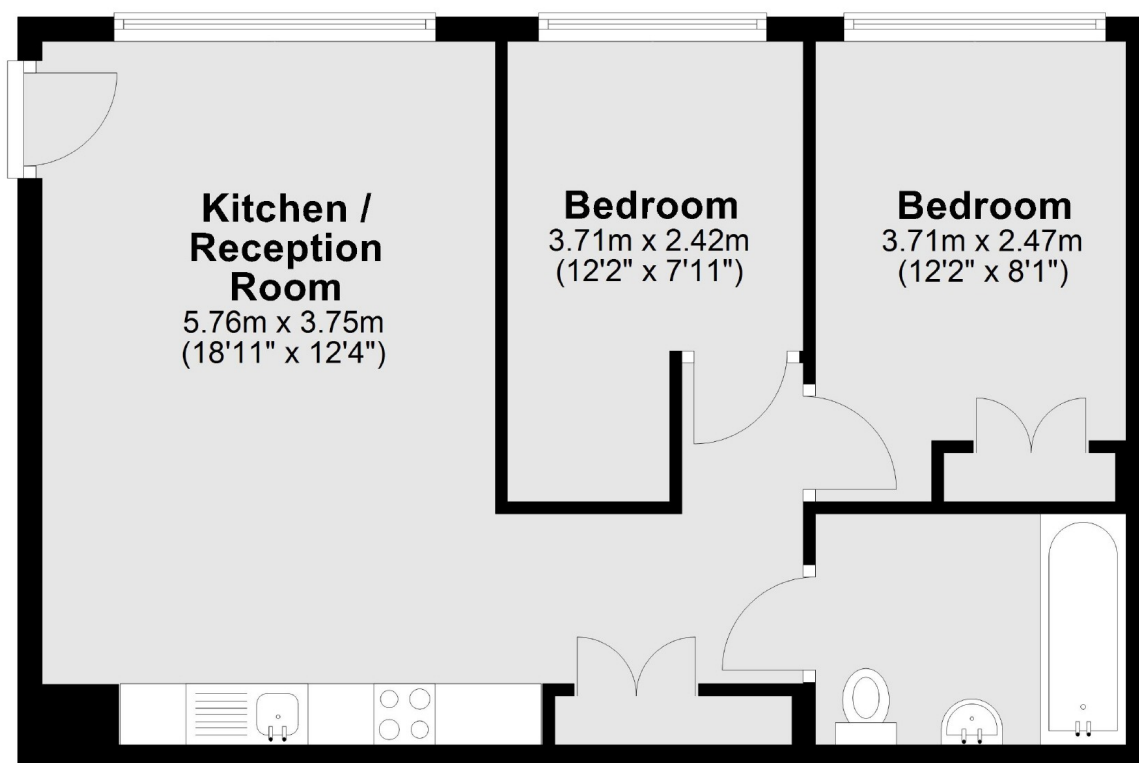

Total area: approx. 51.1 sq. metres (549.9 sq. feet)