

## Bethnal Green Road, E2

### £550,000

This well presented, three double bedroom apartment is located within a factory conversion in the heart of Bethnal Green. It has an open plan kitchen and living area with breakfast bar and double height ceilings. The apartment has an on site concierge and is being sold chain free.

City View House is located with Bethnal Green underground on it's doorstep. Victoria Park is just over half a mile away and the restaurants and bars of Shoreditch and Brick Lane are all at the end of Bethnal Green Road.

### Features

- Three Double Bedrooms
- Communal Roof Terrace
- Secure Entry
- Lift Access
- Concierge
- Chain Free

# Bethnal Green Road, London, E2

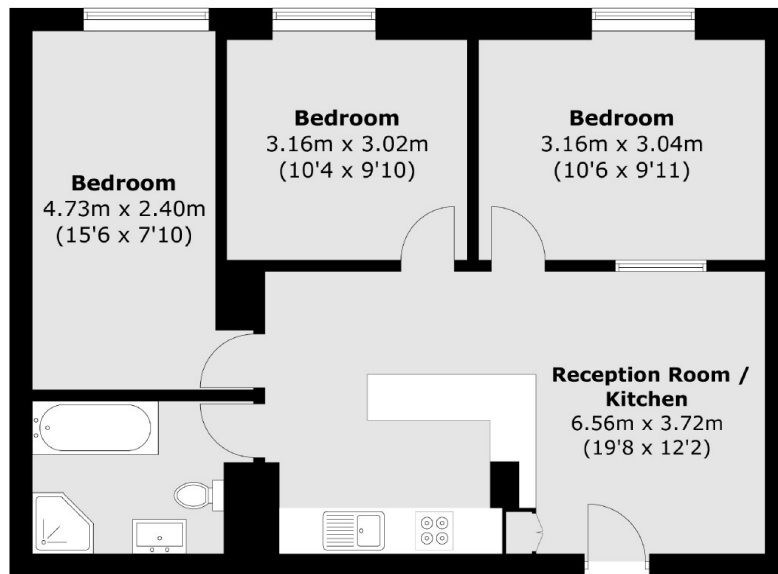

Total area (approx.): 65.8 sq. m (708.2 sq. ft)