



Commercial Road, E1 £300,000

This bright and spacious one bedroom flat is based on the third floor in central Limehouse. The property has a large open plan reception room that is great for entertaining and has large windows with shutter blinds.

Commercial Road is moments away from Limehouse station, which can get you into the City and Canary in minutes and is surrounded by cafés, bars and restaurants.

Features

- One Bedroom
- Bright and Spacious
- Large Reception
- Lift Access
- Open Plan
- Chainfree

Commercial Road, London, E1

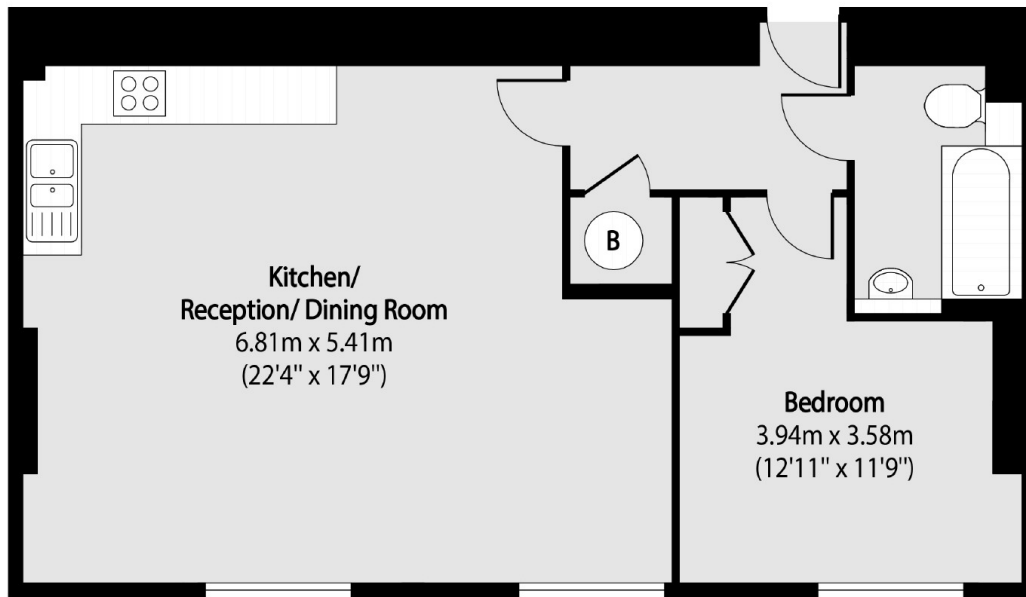

Total area (approx): 56.67 sq m (610 sq. ft)