



Calvin Street, E1

£550,000

A one double bedroom apartment in the heart of Spitalfields on Calvin Street. This property has a large open plan living and kitchen area, floor to ceiling windows with a Juliet balcony, and great storage throughout.

Calvin Street is in the perfect location just off Commercial Street with Spitalfields market just moments away and easy access to Shoreditch High Street station.

Features

- One Bedroom
- Open Plan
- Juliet Balcony
- Central Location
- Built in Storage
- Spitalfields Market Nearby

Calvin Street, London, E1

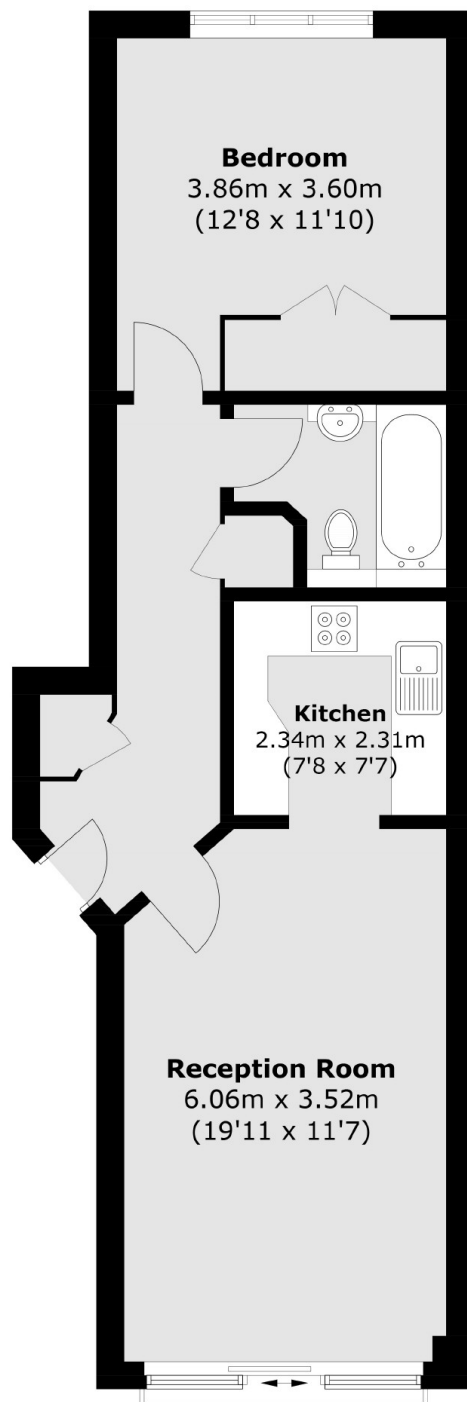

Total area (approx.): 53.9 sq. m (580.2 sq. ft)