



Pepys Street, EC3N

£500,000

This one double bedroom, one bathroom apartment is situated in the heart of Fenchurch Street with a concierge service. The property has a bright open plan reception room and a small private balcony.

Pepys Street has everything on its door step that you could ask for which includes several transport, restaurants, cafés, the Tower of London and so much more.

Features

- One Double Bedroom
- Fifth Floor
- Private Balcony
- Central Location
- Concierge Service
- Open Plan Living

**Pepys Street,
London, EC3N**

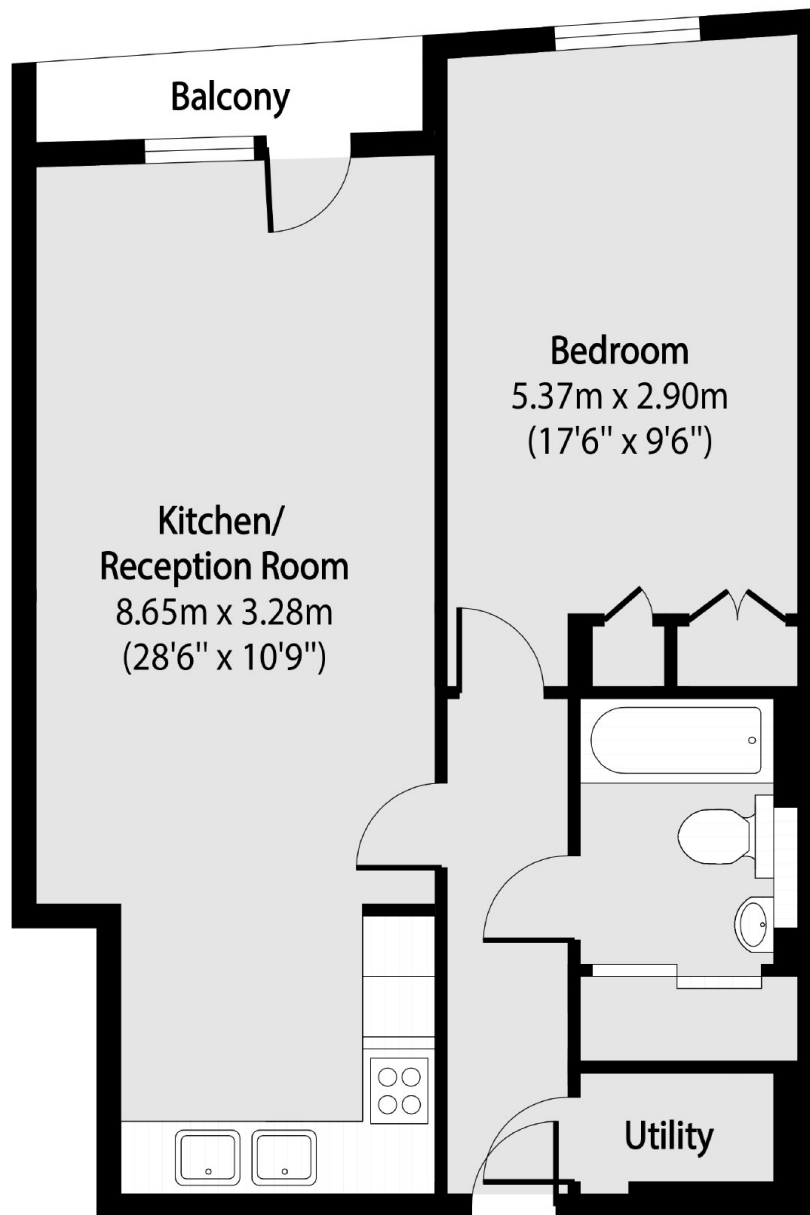

Total area (approx): 54.61 sq m (588 sq. ft)

Balcony total area (approx): 2.40 sq m (26 sq. ft)