



## Middlesex Street, E1

### £400,000

A one bedroom apartment situated on the second floor of a mansion block, with lift access. The property has a spacious reception room with separate kitchen and a generous bedroom.

Middlesex Street is just off Bishopsgate where you are surrounded by restaurants, bars, cafés as well as the famous Spitalfields Market.

### Features

- One Bedroom
- Mansion Block
- Separate Kitchen
- Wooden Flooring
- Lift Access
- Furnished

# Middlesex Street, London, E1

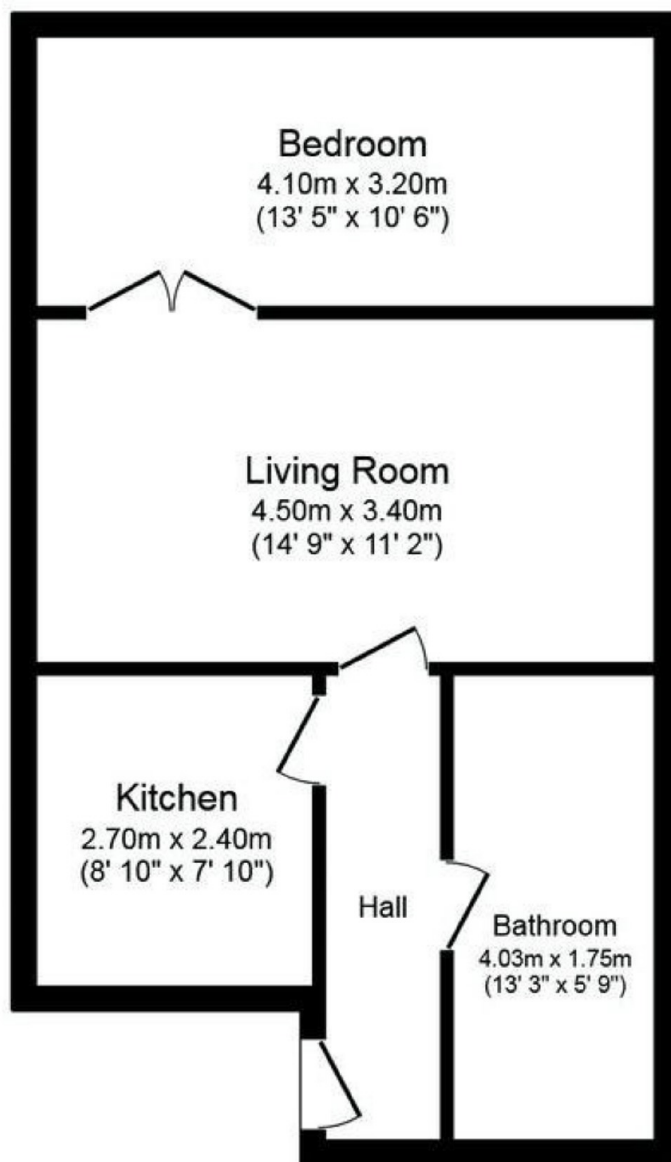

## Floor Plan

Total floor area 47.8 sq.m. (515 sq.ft.) approx

This plan is for illustration purposes only and may not be representative of the property. Plan not to scale.