



Poole Street, N1

£750,000

A spacious two double bedroom, two bathroom apartment located on the sixth floor in the popular development of Gainsborough Studios South, (Alfred Hitchcock's former Films studios). Situated on the door step of Shoreditch Park and Regents Canal. The popular amenities of Shoreditch are also nearby.

Located just over half a mile from Old Street Underground (Northern line), half a mile From Essex Road Station (National Rail) and just over half mile from Haggerston station (National Rail).

Features

- Gainsborough Studios South
- Two Double Bedrooms
- Two Bathrooms
- Balcony Courtyard Facing
- Concierge
- Chain Free

Poole Street, London, N1

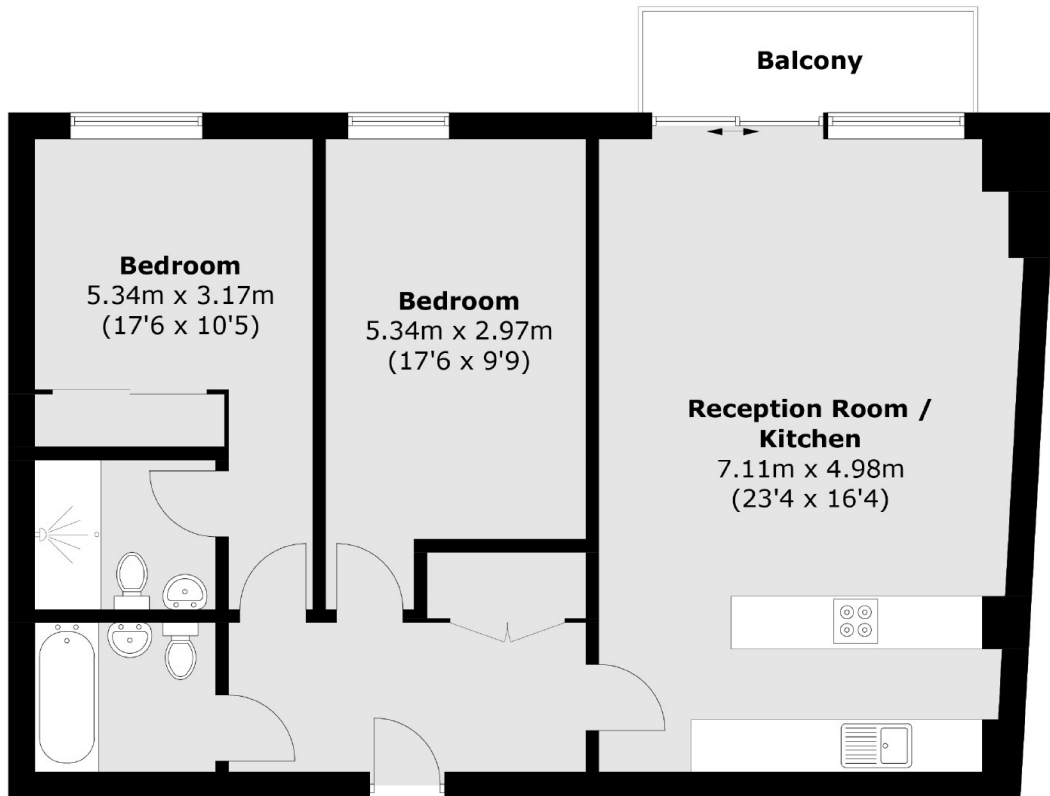

Total area (approx.): 80.3 sq. m (864.3 sq. ft)
Balcony: 4.3 sq. m (46.3 sq. ft)