



Whiston Road, E2

£400,000

A one bedroom apartment located on the top floor of a purpose built block. This property has a modern finish, open plan kitchen and living space with room to dine, a family bathroom and good storage space.

This property is located just of the the thriving Kingsland Road with its many restaurants, cafes and bars. Shoreditch and Broadway Market are just over half a mile walk and the nearest stations are Hoxton and Haggerston under half a mile away.

Features

- One Bedroom
- Modern Finish
- Top Floor
- Good Storage
- Open Plan Living
- Communal Garden

**Whiston Road,
London, E2**

Second Floor

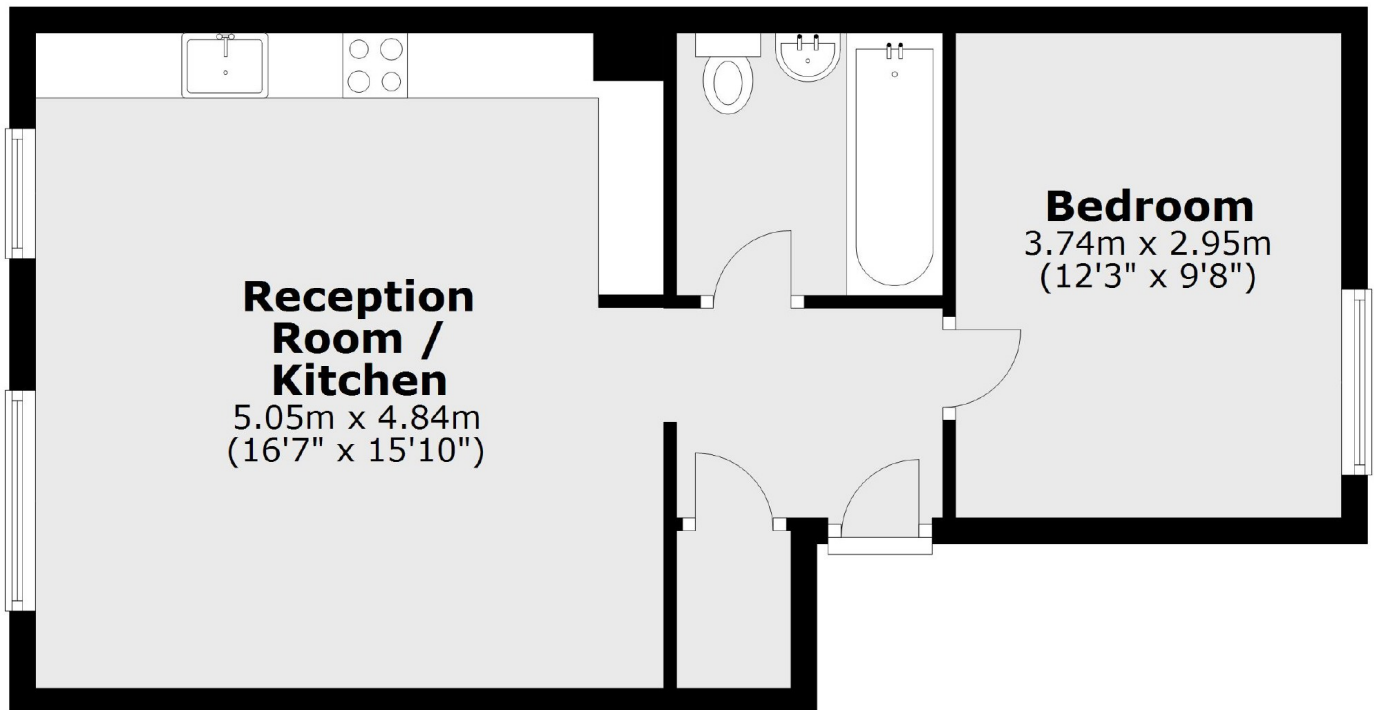

Total area: approx. 42.9 sq. metres (461.9 sq. feet)