



Hebden Street, E2

£450,000

A one bedroom apartment located on the top floor of a modern apartment complex with a south west facing balcony. This property has an open plan kitchen and living space with dedicated area to dine, built in storage and measures over 560 sqft.

This apartment has lift access and is located under a quarter of a mile from Haggerston Park. The popular restaurants and Cafes of Broadway market are just over half a mile away with Hoxton Overground a similar distance.

Features

- OIEO
- Top Floor
- Balcony
- Open Plan
- Lift
- Secure Block

Hebden Street, London, E2

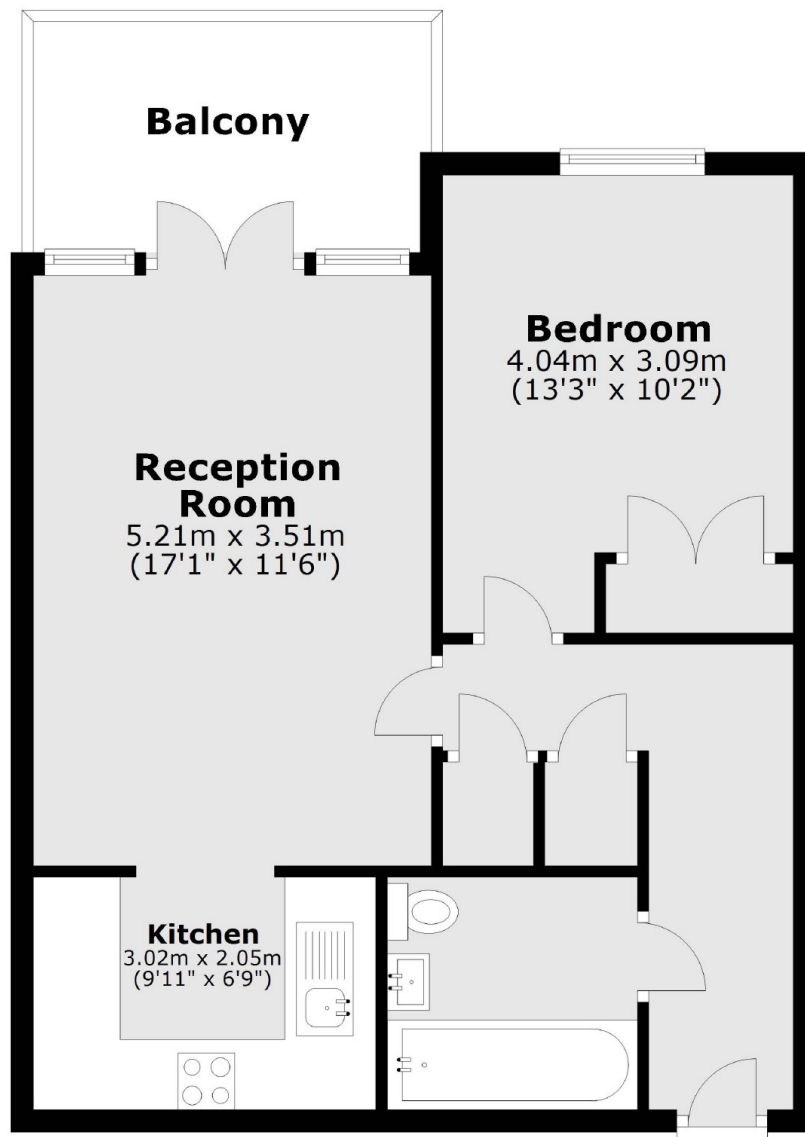

Main area: Approx. 52.0 sq. metres (560.2 sq. feet)
Plus balconies, approx. 7.5 sq. metres (80.8 sq. feet)