

15-17 Eastgate Street, Bury St. Edmunds, Suffolk, IP33 1XX
Tel: 01284 760770
bury@shiresestateagents.co.uk
www.shiresresidential.com

shires

Estate & Letting Agents



Westgate Street, Bury St. Edmunds, Suffolk, IP33 1QG

Rent - £875 PCM Deposit - £1,009

Step into this beautifully refurbished Victorian terraced property on Westgate Street, offering a perfect balance of period charm and modern living. This inviting 1-bedroom, 1-bathroom home has been thoughtfully updated while retaining its character features, creating a warm and welcoming space. A bright living area flows into a sleek, modern kitchen, while the stylish bathroom and comfortable double bedroom provide everything you need for relaxed living. The property also benefits from a versatile basement space, ideal for storage, a home office, or creative use. Situated in a vibrant location with shops, cafés, and excellent transport links close by, this home is perfectly suited to professionals or couples looking for a place with both character and convenience. With on street parking available and a secure shared courtyard garden coupled with diverse transportation links, this property presents a great home. Agents Note - please note that the landlord of this property is a staff member of Abbey Sales & Lettings

- 1 BEDROOM TOWN CENTRE HOUSE
- UPGRADED KITCHEN AND BATHROOM
- AVAILABLE FROM 10TH NOVEMBER
- PARKING PERMIT AREA
- ARRANGE YOUR VIEWING TODAY
- CELLAR
- BEAUTIFULLY REFURBISHED VICTORIAN TOWN HOUSE
- CLOSE TO ALL BURY ST EDMUNDS AMENITIES
- COUNCIL TAX BAND A

Council Tax Band: A - EPC Rating: E 45

BASEMENT
9.9 sq.m. (106 sq.ft.) approx.

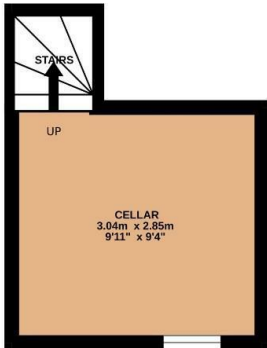

GROUND FLOOR
15.5 sq.m. (167 sq.ft.) approx.

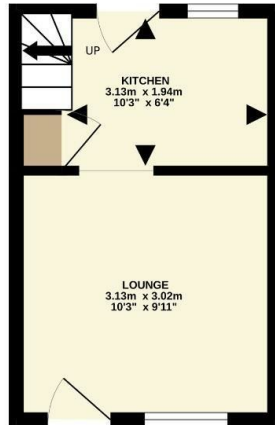

1ST FLOOR
15.5 sq.m. (167 sq.ft.) approx.

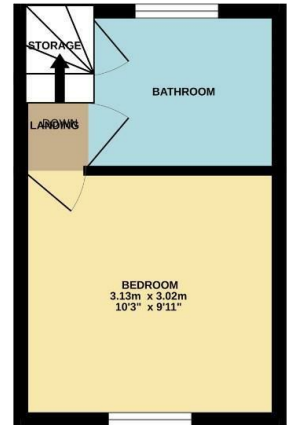

TOTAL FLOOR AREA : 40.9 sq.m. (440 sq.ft.) approx.

Whilst every attempt has been made to ensure the accuracy of the floorplan contained here, measurements of doors, windows, rooms and any other items are approximate and no responsibility is taken for any error, omission or mis-statement. This plan is for illustrative purposes only and should be used as such by any prospective purchaser. The services, systems and appliances shown have not been tested and no guarantee as to their operability or efficiency can be given.
Made with Metropix ©2025

