



Ellis Close, Bury St Edmunds, IP32 7QE

Rent - £1,150 PCM Deposit - £1,326

Available immediately, this new build Coach House located in a cul de sac with garage, drive and own rear garden. Accommodation offers Hall, Landing, Open Plan Kitchen/Dining/Sitting Room, Two Bedrooms and Bathroom. The property has integrated kitchen appliances including oven, hob and extractor fan, fridge freezer, washing machine and dish washer. New carpets and blinds throughout - ready to move in. Contact us to arrange a viewing - sorry no pets.

- NEW 2 BEDROOM COACH HOUSE
- OWN WESTERLY FACING GARDEN
- SOLAR PANEL, GAS RADIATOR HEATING, DOUBLE GLAZING
- FAMILY BATHROOM/WC
- SORRY NO PETS
- GARAGE AND PARKING FOR 1 CAR
- LOW EPC RATING - B
- FITTED KITCHEN WITH INTEGRATED APPLIANCES
- OPEN PLAN LOUNGE/DINING/KITCHEN
- CONTACT US NOW TO BOOK YOUR VIEWING



Council Tax Band: New Build - EPC Rating:

BASEMENT
20.3 sq.m. (219 sq.ft.) approx.

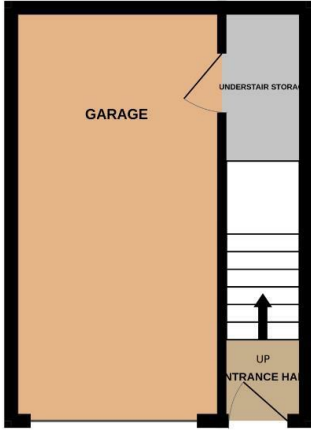

GROUND FLOOR
52.0 sq.m. (560 sq.ft.) approx.

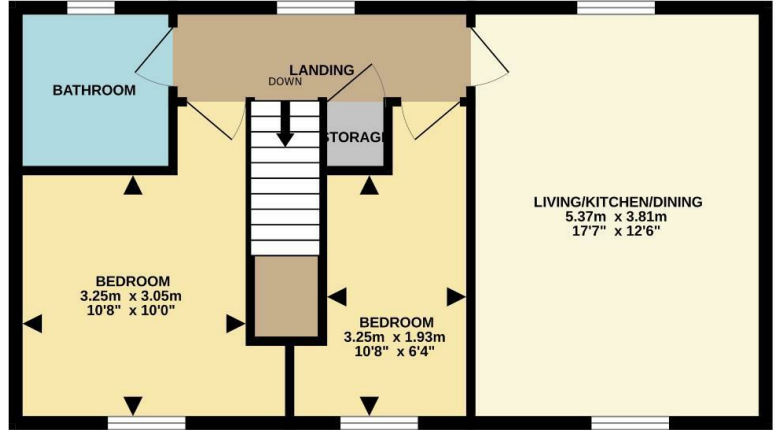

TOTAL FLOOR AREA: 72.4 sq.m. (779 sq.ft.) approx.

Whilst every attempt has been made to ensure the accuracy of the floorplan contained here, measurements of doors, windows, rooms and any other items are approximate and no responsibility is taken for any error, omission or mis-statement. This plan is for illustrative purposes only and should be used as such by any prospective purchaser. The services, systems and appliances shown have not been tested and no guarantee as to their operability or efficiency can be given.
Made with Metropix ©2025

