



Boulters Way, Stowmarket, Suffolk, IP14 1SG

Rent - £875 PCM Deposit - £1,009

VIEWINGS ARE FULLY BOOKED

Shires are pleased to offer to rent this modern two bedroom semi detached bungalow overlooking an area of green to the front. The property is located at the end of a cul de sac and within close proximity to amenities and facilities. The bungalow has the benefit of Gas Fired Central Heating and the accommodation offers Entrance Hall with cloaks cupboard, boiler and meter cupboards, Bathroom, Separate WC, Sitting/Dining Room, Kitchen with electric oven and hob and space for fridge/freezer, Lean To Conservatory with plumbing for washing machine, Two Double Bedroom. The property has the benefit of a Garage and parking space. The rear garden has a good degree of privacy and is fully enclosed and mostly laid to lawn. Sorry no pets.

- SEMI DETACHED BUNGALOW
- SITTING ROOM / DINING ROOM
- CONSERVATORY
- MAIN BATHROOM, SEPARATE WC
- GARAGE, PARKING
- ENTRANCE HALL
- MODERN KITCHEN WITH FITTED ELECTRIC OVEN AND HOB
- TWO DOUBLE BEDROOMS
- FRONT AND REAR GARDEN
- GAS CH, EPC 68, D



Council Tax Band: B - EPC Rating: C 72

GROUND FLOOR

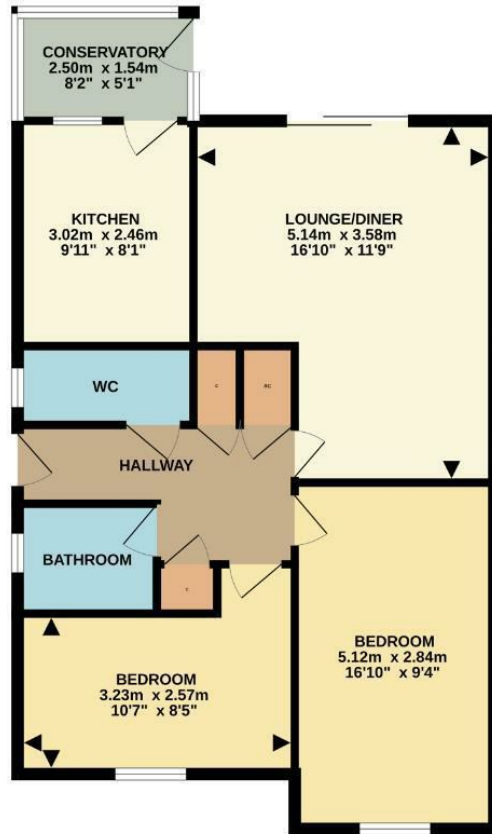

Whilst every attempt has been made to ensure the accuracy of the floorplan contained here, measurements of doors, windows, rooms and any other items are approximate and no responsibility is taken for any error, omission or misstatement. This plan is for illustrative purposes only and should be used as such by any prospective purchaser. The services, systems and appliances shown have not been tested and no guarantee as to their operability or efficiency can be given.
Made with Metropex ©2023

