



Manor Ash Drive, Bury St. Edmunds, Suffolk, IP32 7HN

Rent - £1,150 PCM Deposit - £1,326

Shires are pleased to offer To Let this modern terraced house located on the popular Moreton Hall development within good access of all the amenities the area has to offer. The accommodation comprises Entrance Hall, Kitchen, Living Room, Bedroom One with En Suite Shower Room, Bedroom Two and Family Bathroom. The property further benefits from an enclosed rear garden and allocated parking. The property has gas fired central heating and is available to view now and to move in early April.

- MODERN TERRACED HOUSE
- KITCHEN WITH ELECTRIC OVEN AND GAS HOB
- SECOND BEDROOM AND BATHROOM
- EPC 75, C, GAS FIRED HEATING
- MINIMUM TERM TENANCY OF TWELVE MONTHS
- ENTRANCE HALL, LIVING ROOM
- BEDROOM ONE WITH EN SUITE-SHOWER ROOM
- REAR GARDEN, PARKING
- UNFURNISHED, COUNCIL TAX BAND B
- AVAILABLE EARLY APRIL



Council Tax Band: B - EPC Rating: C 75

GROUND FLOOR

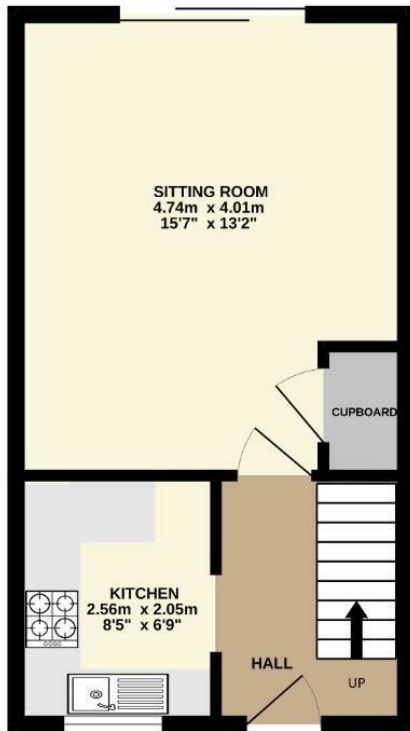

1ST FLOOR



Whilst every attempt has been made to ensure the accuracy of the floorplan contained here, measurements of doors, windows, rooms and any other items are approximate and no responsibility is taken for any error, omission or mis-statement. This plan is for illustrative purposes only and should be used as such by any prospective purchaser. The services, systems and appliances shown have not been tested and no guarantee as to their operability or efficiency can be given.
Made with Metropix 5/2022.

