

15-17 Eastgate Street, Bury St Edmunds, Suffolk, IP33 1XX
Tel: 01284 760770
bury@shiresresidential.com
www.shiresresidential.com



Rockingham Road, Bury St. Edmunds, Suffolk, IP33 2SE

Rent - £1,300 PCM Deposit - £1,500

Shires Residential are delighted to offer this two bedroom end terrace property located in a cul de sac location close to Bury St Edmunds town centre and all its amenities. The property has been refurbished and is well presented and in good decorative order with a new kitchen and modern bathroom suite. The accommodation comprises Entrance Hall with stairs to first floor, Sitting Room, modern Kitchen/Dining Room with door to rear garden. On the first floor there are two good sized Bedrooms and Bathroom.

Outside the property is in a good location overlooking a wooded area. The property has gardens which have been landscaped for ease of maintenance and parking. The property has the benefit of gas fired central heating and should be viewed to appreciate the location and the accommodation on offer.

- MODERN END OF TERRACE HOUSE
- TWO DOUBLE BEDROOMS
- NEW KITCHEN AND BATHROOM
- COURTYARD GARDEN AND PARKING
- FULLY REFURBISHED
- GREAT TUCKED AWAY LOCATION - CONVENIENT FOR TOWN
- GAS RADIATOR HEATING - ENERGY RATING D
- SORRY NO PETS - COUNCIL BAND C
- AVAILABLE IMMEDIATELY



Council Tax Band: C - EPC Rating: D 63

GROUND FLOOR
29.0 sq.m. (312 sq.ft.) approx.

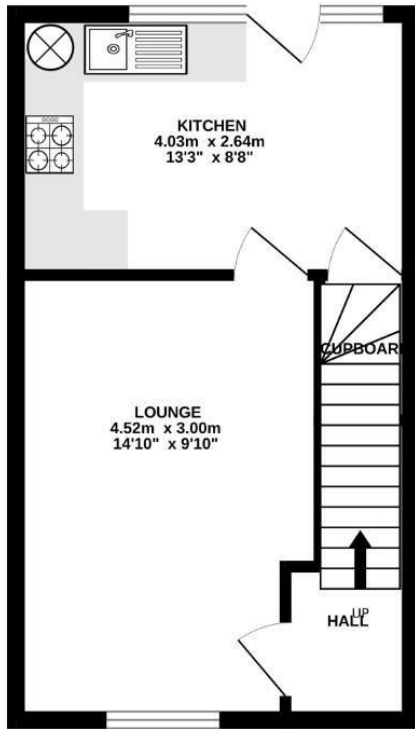

1ST FLOOR
29.0 sq.m. (312 sq.ft.) approx.

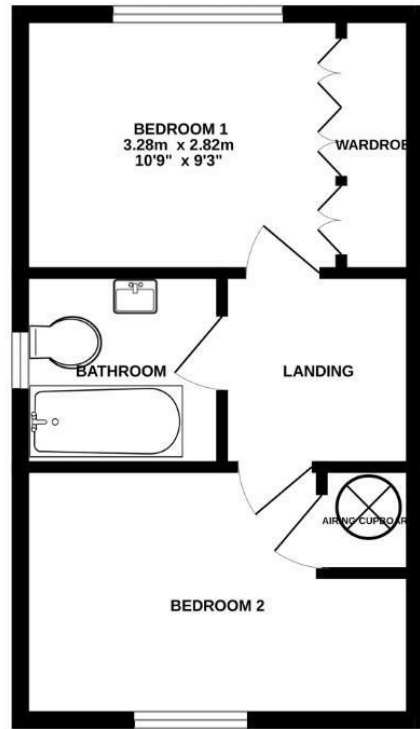

TOTAL FLOOR AREA : 58.0 sq.m. (625 sq.ft.) approx.

Whilst every attempt has been made to ensure the accuracy of the floorplan contained here, measurements of doors, windows, rooms and any other items are approximate and no responsibility is taken for any error, omission or mis-statement. This plan is for illustrative purposes only and should be used as such by any prospective purchaser. The services, systems and appliances shown have not been tested and no guarantee as to their operability or efficiency can be given.
Made with Metropix ©2024.

