



## Barleyfields, Bury St. Edmunds, Suffolk, IP31 3TF

Rent - £1,100 PCM      Deposit - £1,269

Beautifully presented semi-detached house located in the popular village of Thurston and in walking distance of local amenities and schools. The property benefits from an Entrance Hall, Cloakroom, Sitting Room with stairs to first floor, Kitchen/Dining Room, 3 Bedrooms & Bathroom. The property also offers driveway parking & good size gardens to front and rear. Pets are not accepted. We highly recommend arranging a viewing as soon as possible.

- SEMI-DETACHED HOUSE
- KITCHEN/ DINING ROOM
- 3 BEDROOMS (ONE WITH FITTED WARDROBES)
- FRONT AND REAR GARDEN, PARKING FOR AT LEAST 2 CARS
- MINIMUM TERM CONTRACT TWELVE MONTHS
- ENTRANCE HALL, CLOAKROOM
- SITTING ROOM
- FAMILY BATHROOM
- EPC 71, C, GAS CH, UNFURNISHED
- COUNCIL TAX BAND B



Council Tax Band: B - EPC Rating: C 71

GROUND FLOOR

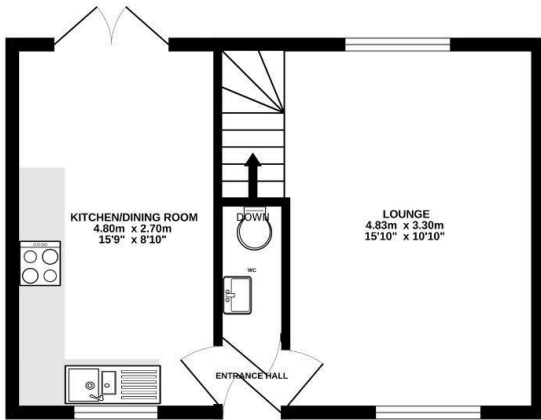

1ST FLOOR

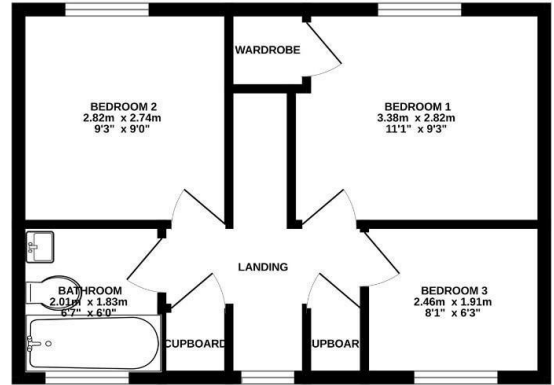

BARLEYFIELDS, THURSTON, BURY ST EDMUNDS

Whilst every attempt has been made to ensure the accuracy of the floorplan contained here, measurements of doors, windows, rooms and any other items are approximate and no responsibility is taken for any error, omission or mis-statement. This plan is for illustrative purposes only and should be used as such by any prospective purchaser. The services, systems and appliances shown have not been tested and no guarantee as to their operability or efficiency can be given.  
Made with Metropix ©2024

