

15-17 Eastgate Street, Bury St Edmunds, Suffolk, IP33 1XX
Tel: 01284 760770
bury@shiresresidential.com
www.shiresresidential.com

shires

residential



Codling Road, Bury St. Edmunds, Suffolk, IP32 7HE

Rent - £1,125 PCM Deposit - £1,298

Excellent, well presented house on the popular Moreton Hall development with two double bedrooms. The property offers an attractive, hard landscaped garden and two parking spaces. Sorry, no pets.

Virtual Tour Viewings

Please be informed that it is not possible to give more than a general impression of the size, quality and general layout of the property available to let and this should only be seen as for guidance purposes only. Where possible,

- MODERN TERRACED HOUSE
- KITCHEN WITH ELECTRIC OVEN AND HOB
- TWO DOUBLE BEDROOMS, BOTH WITH FITTED WARDROBES
- REAR LANDSCAPED GARDEN WITH SHED
- TWO ALLOCATED PARKING SPACES, EPC C
- ENTRANCE HALL
- SITTING/ DINING ROOM
- BATHROOM
- GAS CENTRAL HEATING, COUNCIL TAX BAND B
- MINIMUM TERM TENANCY OF TWELVE MONTHS



Council Tax Band: B - EPC Rating: C 71

GROUND FLOOR

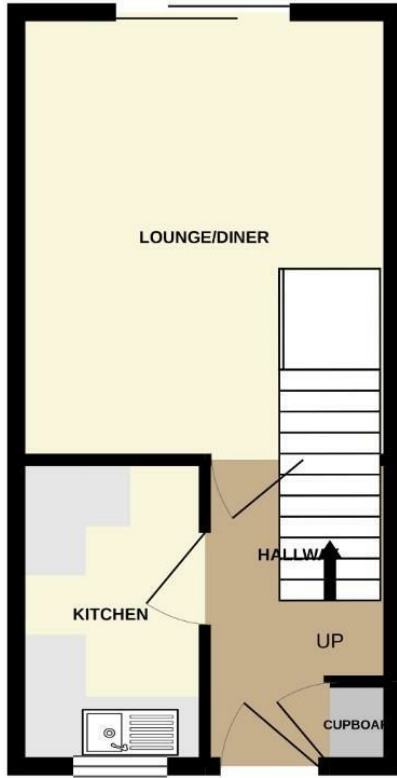

1ST FLOOR

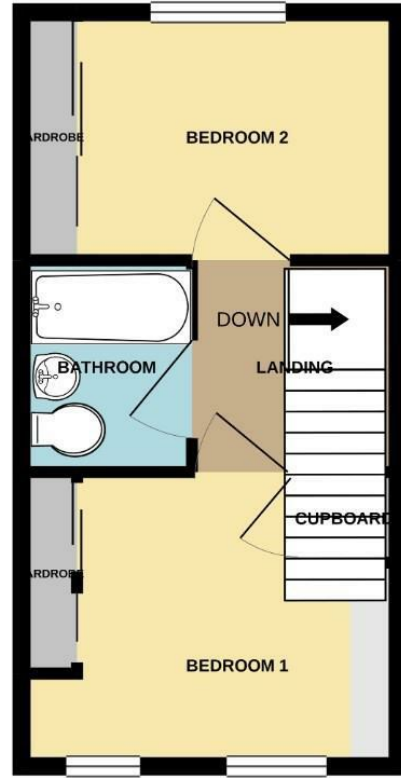

Whilst every attempt has been made to ensure the accuracy of the floorplan contained here, measurements of doors, windows, rooms and any other items are approximate and no responsibility is taken for any error, omission or mis-statement. This plan is for illustrative purposes only and should be used as such by any prospective purchaser. The services, systems and appliances shown have not been tested and no guarantee as to their operability or efficiency can be given.
Made with Metropix ©2021.

