



Floral Street, WC2E

£923 Per week

Dexters



Floral Street, WC2E

A fantastic two bedroom two bathroom flat set in a popular portered development in the heart of Covent Garden. The property consists of a spacious reception room, two double bedrooms with built in storage space, a separate fully integrated kitchen and modern bathroom. The development benefits from a lift and daytime porter. The apartment is set in an unbelievable location in the heart of Covent Garden with the Piazza around the corner.

The property is centrally located in the heart of Covent Garden, Leicester Square, and offers a unique lifestyle in the heart of London's cultural centre just a moment from Covent Garden Piazza.

Features

- Two Double Bedrooms
- Two Bathrooms
- Wood flooring
- Spacious Bedrooms
- 2nd floor
- Concierge



Floral Street, London, WC2E

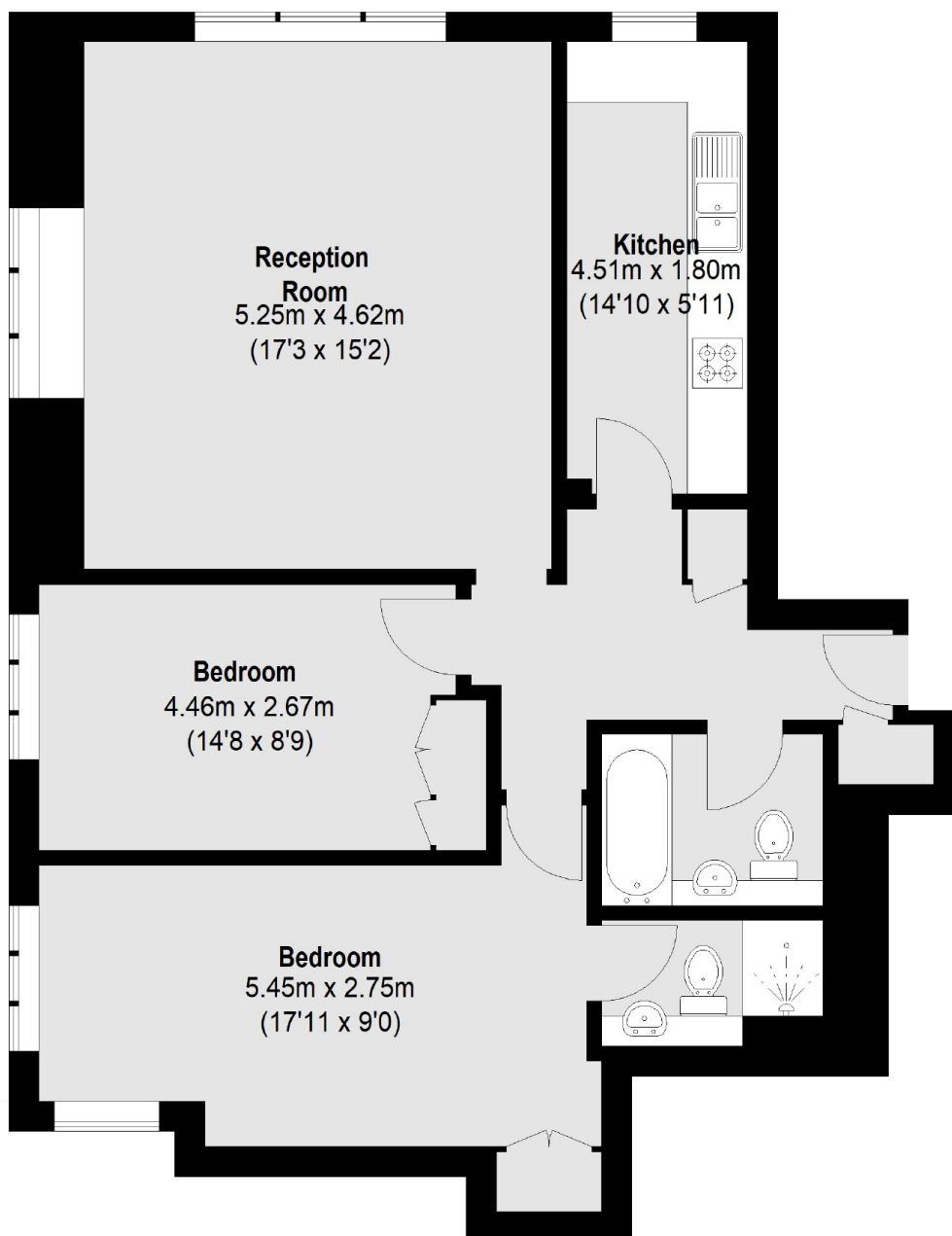

Total area (approx.): 78.05 sq. m (840 Sq. ft)