



Gresse Street, W1T

£550,000

A bright two bedroom apartment with a private balcony. Located a short distance from the Universities and Colleges of the area.

Located in a quiet no through street set behind Oxford Street and Tottenham Court Road. The amenities of the West End are accessible on foot.

Features

- Low Service Charges
- Reception-Dining Room
- Balcony
- Modern Kitchen & Bathroom
- Two Passenger Lifts
- Wood Floors

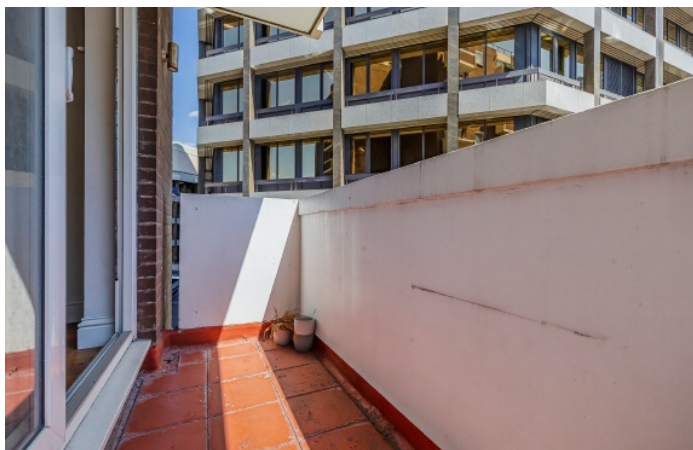

Gresse Street, WIT

The property has a reception/dining room with wood floors and a sliding door opening to a balcony. There are two bedrooms, a modern kitchen and a shower room.



Gresse Street, London, W1T

Third Floor

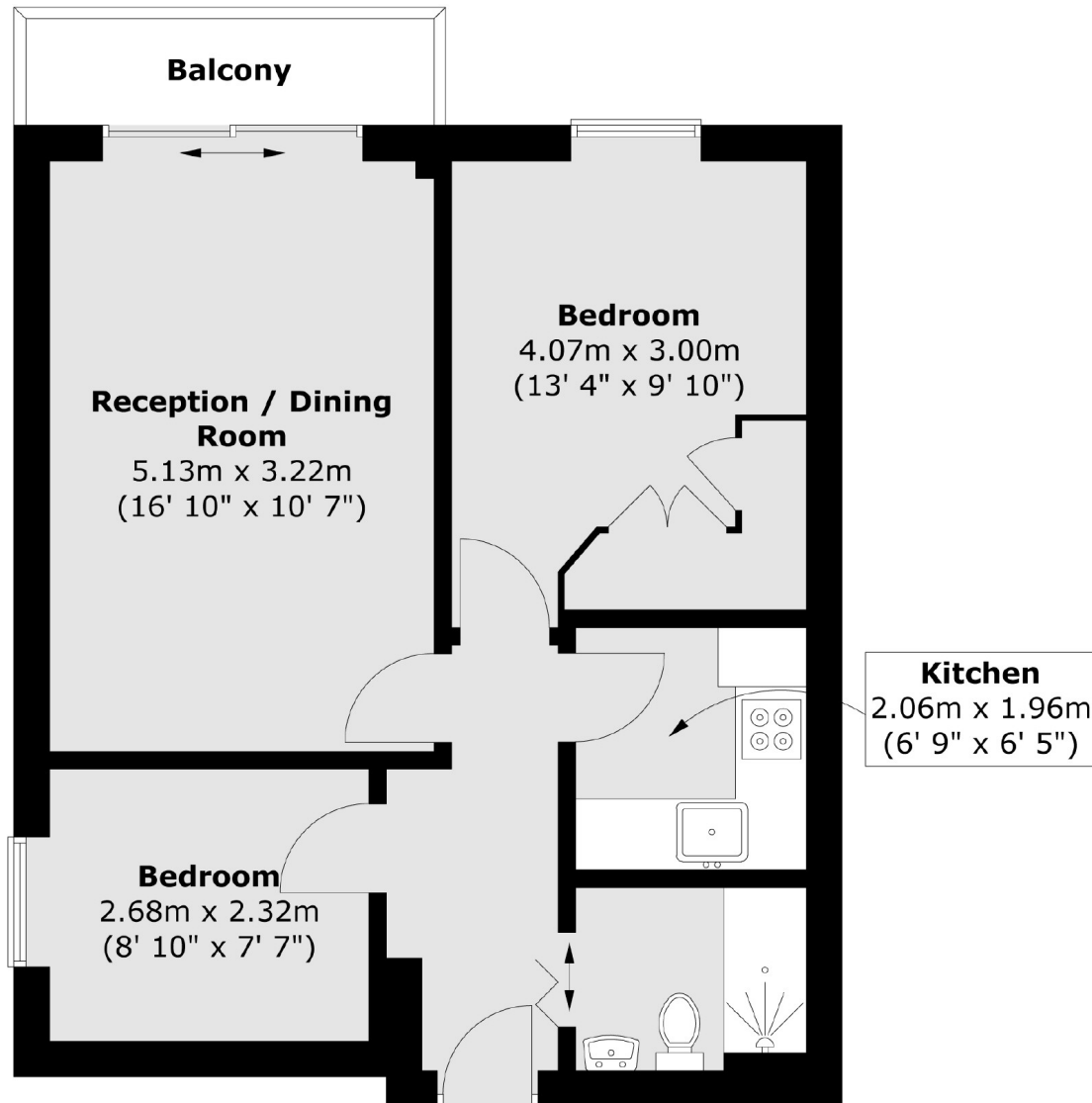

Total area (approx.) : 49.5 sq. m (533 sq. ft)
Total balcony area (approx.) : 2.4 sq. m (26 sq. ft)