



## Gresse Street, W1T

£625,000

A two bedroom apartment with a private balcony.  
Situated in a purpose built block a short distance from  
Tottenham Court Road Station.

Located in a quiet no through street set behind Oxford  
Street and Tottenham Court Road. The amenities of the  
West End are accessible on foot.

### Features

Two Bedrooms  
Purpose Built Apartment  
Reception-Dining Room  
Balcony  
Two Lifts



## Gresse Street, W1T

The property has a reception/dining room with wood floors and a sliding door opening to a balcony. There are two bedrooms, a modern kitchen and a shower room.





# Gresse Street, London, W1T

## Third Floor

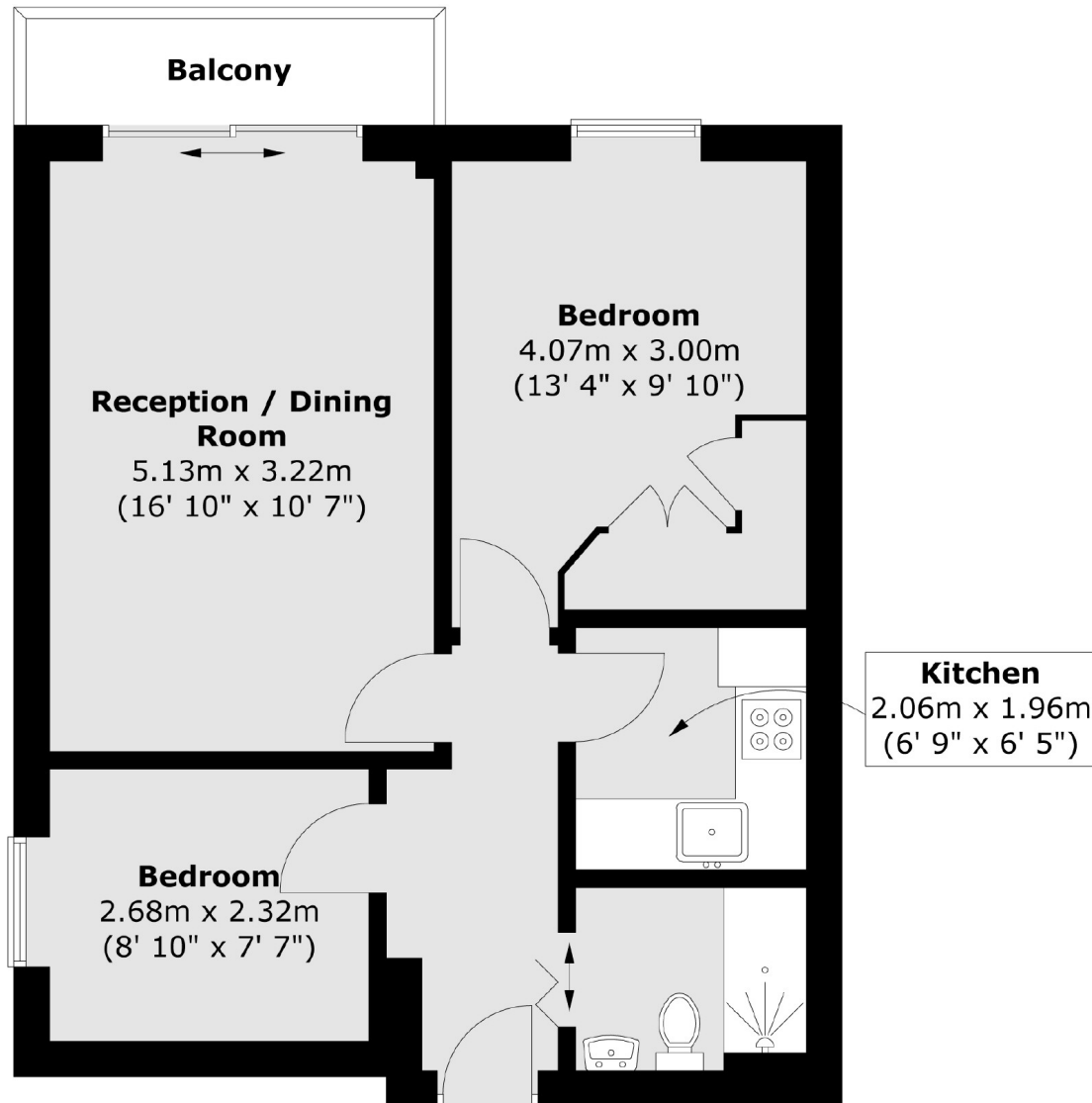

Total area (approx.) : 49.5 sq. m (533 sq. ft)  
Total balcony area (approx.) : 2.4 sq. m (26 sq. ft)