



Pearson Square, W1T

£2,100 Per week

An eighth floor two bedroom, two bathroom apartment with views over London, in the heart of Fitzrovia.

Pearson Square is located in the heart of Fitzrovia with all its local amenities just moments away. Goodge Street, Great Portland Street and Oxford Circus Stations are all a short walk away.

Features

Eighth Floor Apartment
Two Double Bedrooms
24 Hour Concierge
Gym
Cinema
1165 Sq Ft



Pearson Square, W1T

This spacious apartment includes a balcony overlooking the courtyard and far reaching views over London, separate kitchen and utility room, master bedroom complete with a fitted walk in wardrobe and luxurious en-suite, a further bedroom and bathroom.

The apartment was designed by acclaimed interior architects, Studio Mercer. This property further includes bespoke features like; Carrara stone and brass detailing in the two bathrooms, fireplace, designer Vola taps and customised LED lighting. Luxurious Zimmer and Rhode fabrics also run throughout the apartment.

The property also benefits from a complete home automation system that includes; audio, lighting and video distribution.

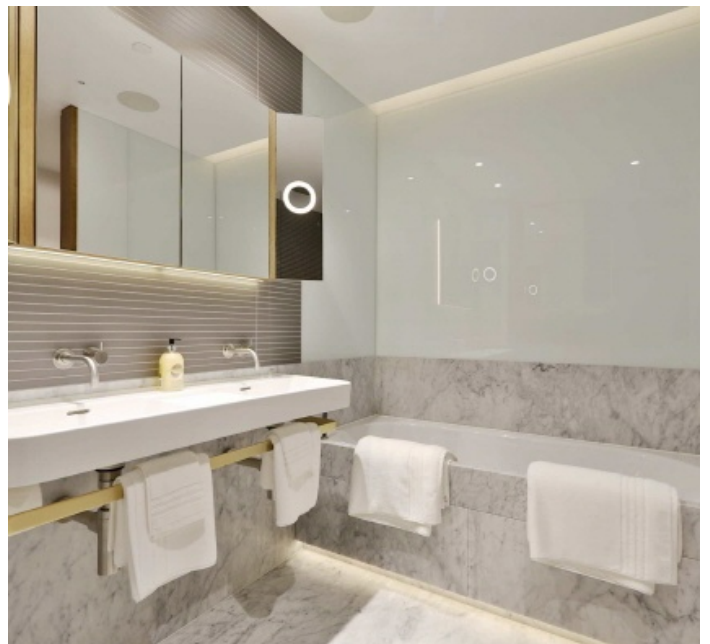

Pearson Square, London, W1T

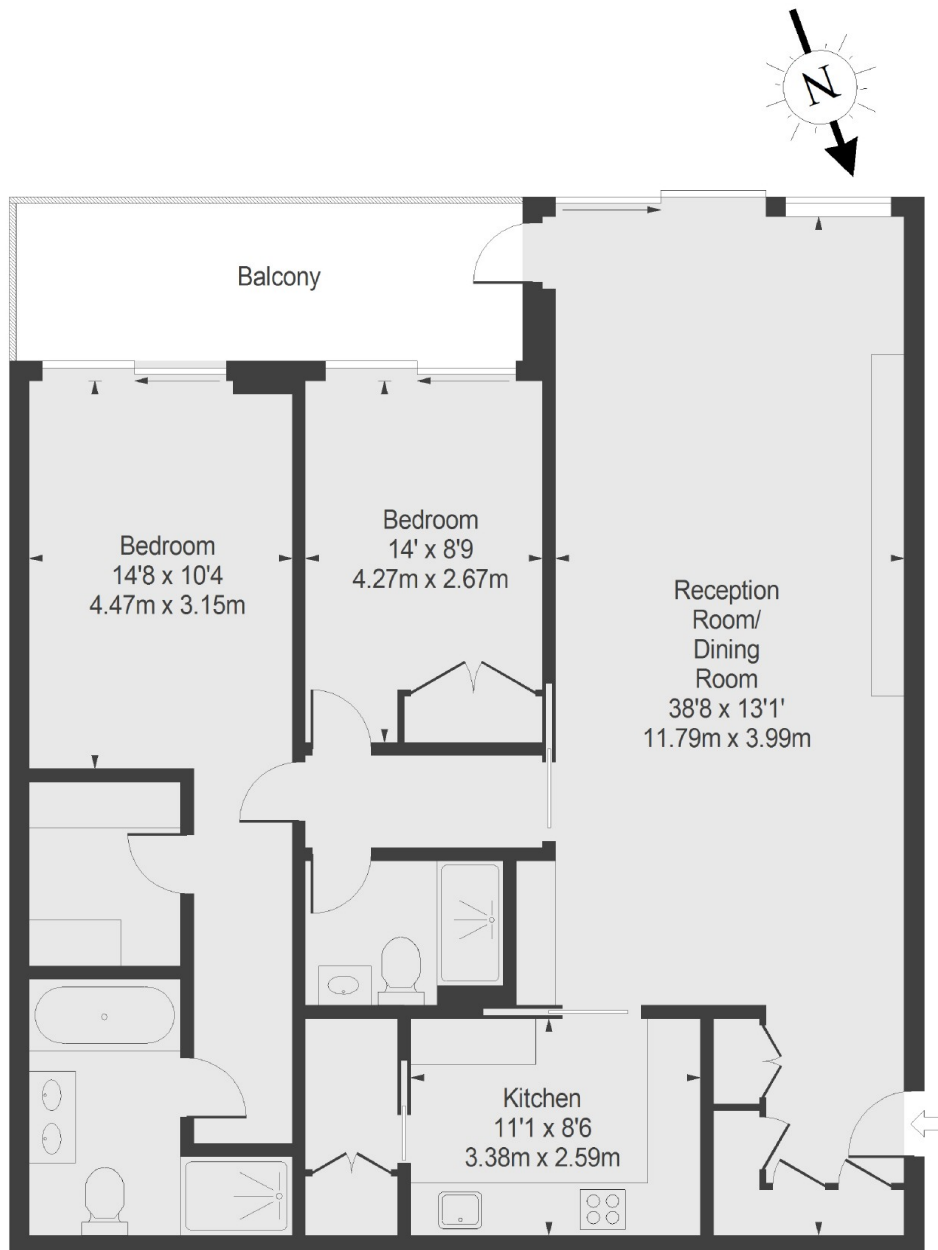

Eighth Floor

PEARSON SQUARE

Total Approx. Floor area 1165 Sq Ft. (108.28 Sq M)

Dexters

Fitzrovia & Covent Garden
66 Goodge Street
London
W1T 4NG
Lettings
020 7067 2402

Energy Rating: B. We aim to make our particulars both accurate and reliable. However they are not guaranteed; nor do they form part of an offer or contract. If you require clarification on any points then please contact us, especially if you're traveling some distance to view. Please note that appliances and heating systems have not been tested and therefore no warranties can be given as to their good working order.

 **RICS** | Regulated
Estate Agent
and Letting Agent

[dexters.co.uk](https://www.dexters.co.uk)