



## Bourlet Close, W1W

£1,730 Per week

This three double bedroom modern mews house is set within a cobbled mews in central Fitzrovia and features a south easterly facing living room and kitchen.

The property is tucked away to the north of Mortimer Street, and within half a mile of Goodge Street, Oxford Circus and Great Portland Street.

### Features

- Three Bedrooms
- Three Bathrooms
- Balcony
- Central Location
- Recently Refurbished
- Private Garage

# Bourlet Close, London, W1W

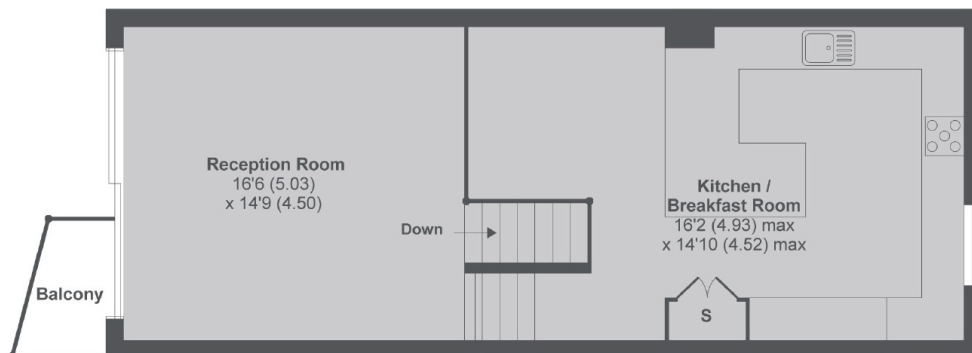

2nd Floor



1st Floor

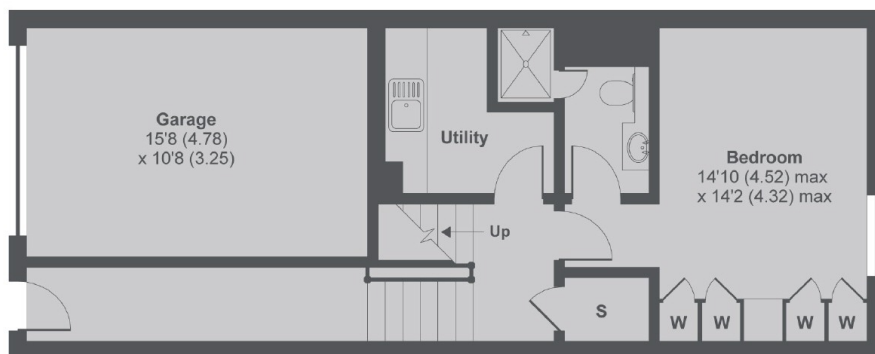

Ground Floor

## Bourlet Close, W1W

MAIN HOUSE APPROX FLOOR AREA 1549 SQ.FT 143.9 SQ.M  
GARAGE APPROX FLOOR AREA 175 SQ.FT 16.2 SQ.M  
TOTAL APPROX FLOOR AREA 1724 SQ.FT 160.1 SQ.M

Copyright nichecom.co.uk 2016 Produced for Dexters REF : 119246

# Dexters

Fitzrovia & Covent Garden  
66 Goodge Street  
London  
W1T 4NG  
Lettings  
020 7067 2402

Energy Rating: D. We aim to make our particulars both accurate and reliable. However they are not guaranteed; nor do they form part of an offer or contract. If you require clarification on any points then please contact us, especially if you're traveling some distance to view. Please note that appliances and heating systems have not been tested and therefore no warranties can be given as to their good working order.

**RICS** Regulated  
Estate Agent  
and Letting Agent

dexters.co.uk