



Fitzroy Street, W1T

£500 Per week

A bright one double bedroom apartment situated on the sixth floor of Fitzroy Street development, conveniently located just off Goodge Street in the heart of Fitzrovia. The property is in the well maintained King Regents Heights building which has a lift access.

Fitzroy Street is located just south of Fitzroy Square and is less than half a mile from Warren Street and Great Portland Street. There is a wide variety of shops and restaurants available on nearby Tottenham Court Road and Goodge Street.

Features

- One Bedroom
- Sixth Floor
- Lift Access
- Separate Kitchen
- Central Location
- Good Natural Light

Fitzroy Street, London, W1T

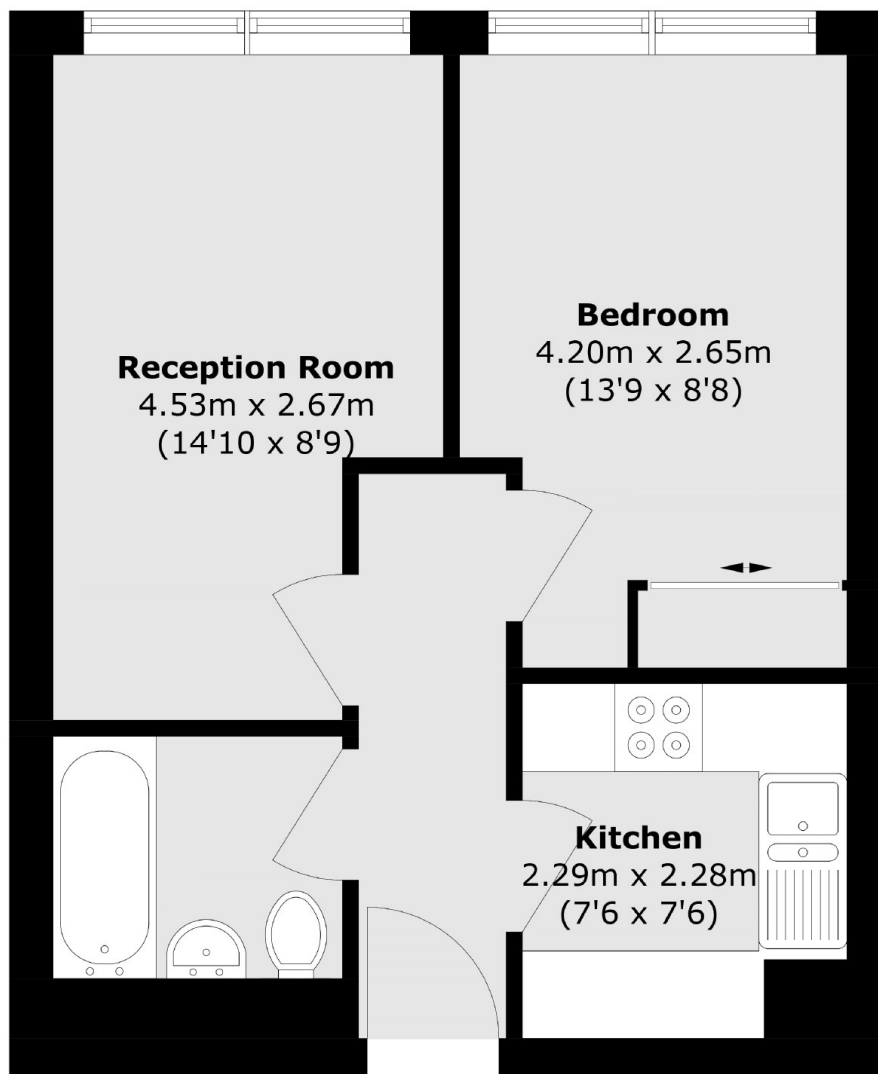

Total area (approx.): 36.5 sq. m (392.8 sq. ft)