



Whitfield Street, W1T

£600 Per week

A modern and well designed two bedroom property in a excellent location close to Warren Street station and Tottenham Court Road.

Located just off Fitzroy Square Garden with access to the wide variety of local shops, restaurants and bars of Goodge Street and Tottenham Court Road.

Features

Central Location
Two Bedroom
Periodic Building
Quiet Location
Great Storage
Modern

**Whitfield Street,
London, W1T**

Second Floor

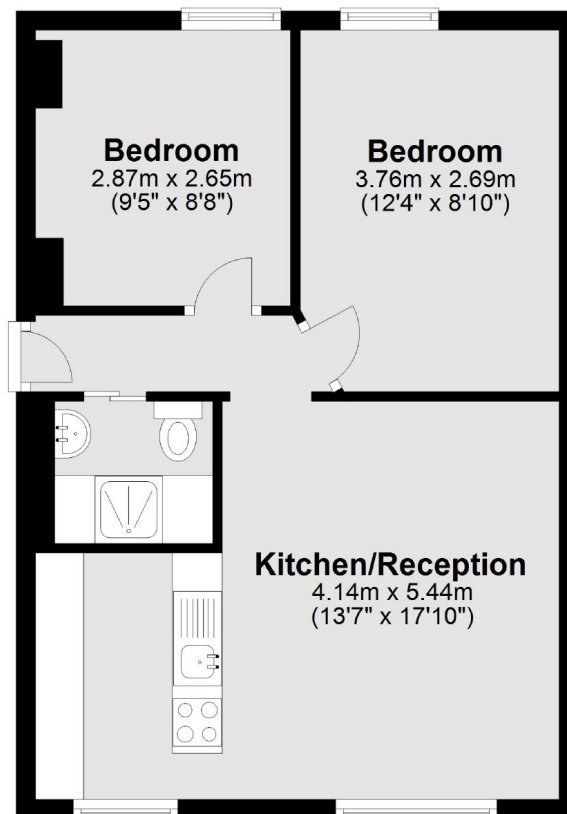

Total area: approx. 43.5 sq. metres (468.2 sq. feet)

Dexters

Fitzrovia & Covent Garden
66 Goodge Street
London
W1T 4NG
Lettings
020 7067 2402

Energy Rating: C. We aim to make our particulars both accurate and reliable. However they are not guaranteed; nor do they form part of an offer or contract. If you require clarification on any points then please contact us, especially if you're traveling some distance to view. Please note that appliances and heating systems have not been tested and therefore no warranties can be given as to their good working order.

 **RICS** | Regulated
Estate Agent
and Letting Agent

[dexters.co.uk](https://www.dexters.co.uk)