



Rathbone Place, W1T

£1,200 Per week

Dexters



Rathbone Place, W1T

Rathbone Place in Fitzrovia offers an exceptional living experience with its central location, vibrant neighbourhood, and a host of amenities. Situated in the heart of London, it provides an easy access to the city's main attractions, business districts, and excellent transportation options.

The neighbourhood's dynamic cultural scene, diverse dining options, and rich lifestyle create a unique atmosphere. Plus, with spa facilities, a swimming pool, a state-of-the-art gym, and a cinema room on-site, residents can enjoy a truly luxurious and convenient living experience in one of London's most exciting neighbourhood.

Features

- 24 hour concierge
- Prime central location
- Air conditioned
- Spa facilities
- Cinema room
- Luxury finish



Rathbone Place, London, W1T

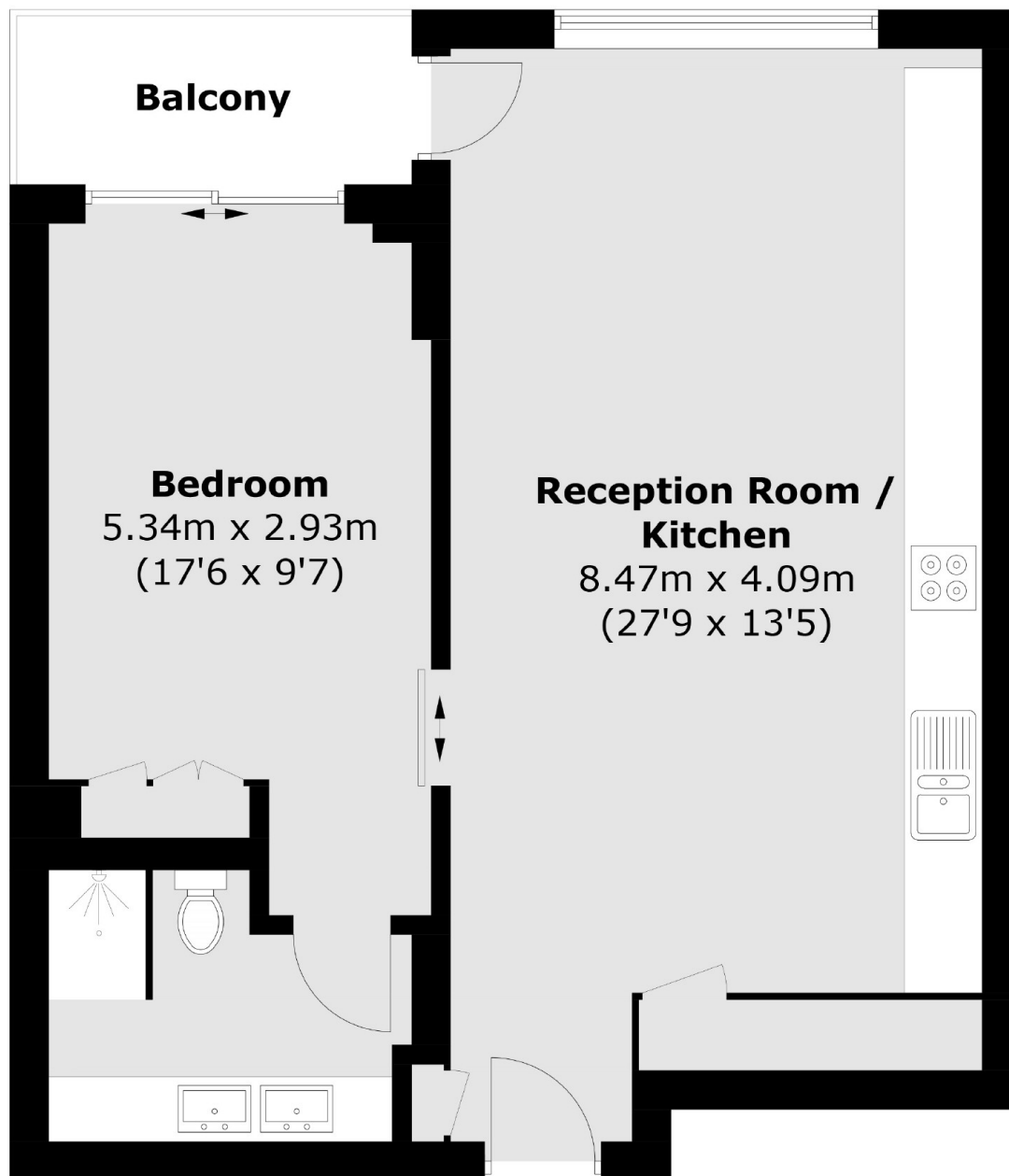

Total area (approx.): 55.7 sq. m (599.5 sq. ft)
Balcony: 4.0 sq. m (43.0 sq. ft)