



Cleveland Street, W1T

£575 Per week

A one bedroom apartment in this Period Conversion located on Cleveland Street in the heart of historic Fitzrovia moments from the amenities of the area.

Located in Zone 1 moments from Great Portland Street Station (Hammersmith & City, Circle and Metropolitan lines) and Warren Street (Northern and Victoria) Station. The green space of Regents Park and the amenities of Fitzrovia and Marylebone are easily accessible.

Features

- One Bedroom
- Open Plan Kitchen
- High Ceilings
- Period Conversion
- First Floor
- Modern Communal Area

Cleveland Street, London, W1T

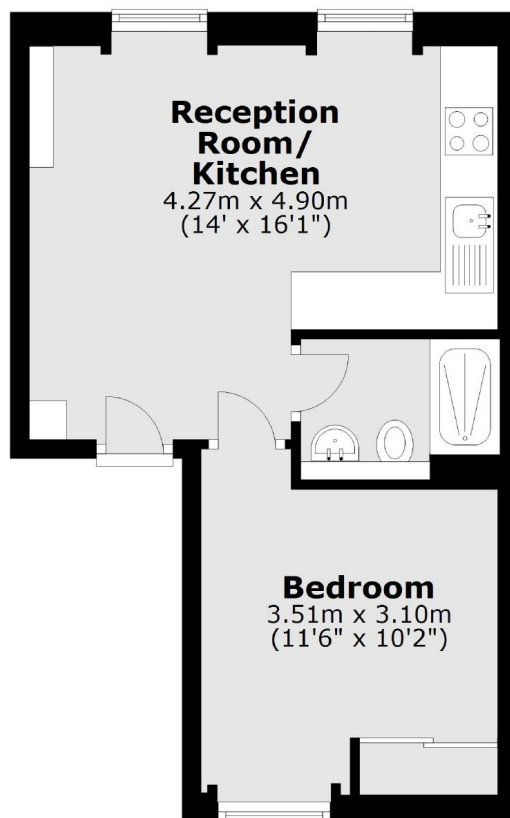

Total area: approx. 32.6 sq. metres (350.9 sq. feet)