



Gresse Street, W1T

£725 Per week

A recently refurbished two bedroom property with a balcony and wooden floors throughout. The property is centrally located on this popular street in the heart of Fitzrovia.

The property is located in the heart of Fitzrovia and Oxford Street, Goodge Street and Regent Street are all within half a mile away from the property.

Features

- Two Bedroom
- Central Location
- Furnished
- Wooden Floors
- Balcony
- Lift

Gresse Street, London, W1T

Third Floor

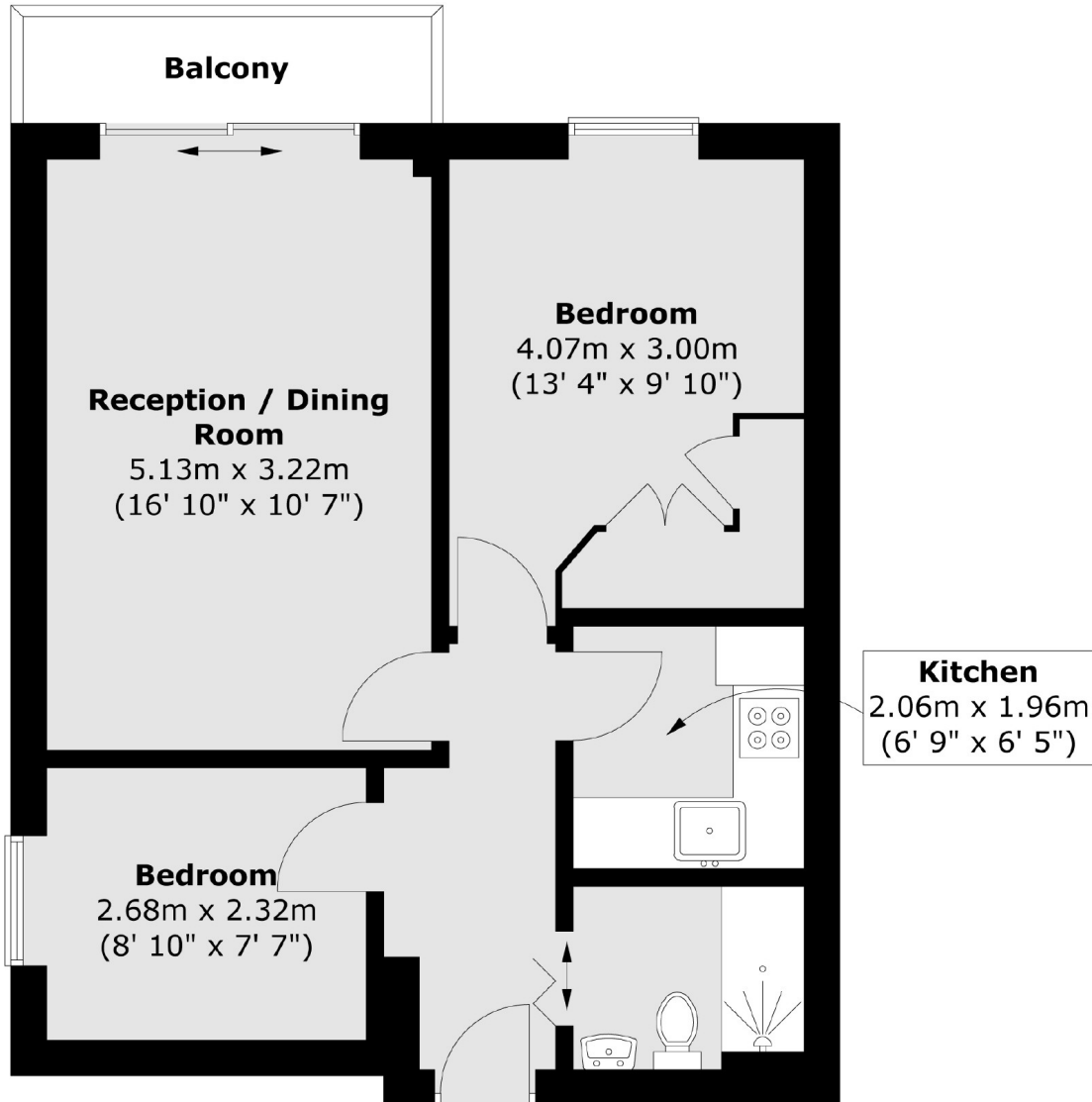

Total area (approx.) : 49.5 sq. m (533 sq. ft)
Total balcony area (approx.) : 2.4 sq. m (26 sq. ft)