

Ridgmount Street, WC1E

£850 Per week

This stylish and exceptionally spacious one double bedroom apartment has been meticulously designed with attention to detail and high-quality finishes.

Ridgmount Street runs between Gower Street and Tottenham Court Road. Oxford Circus and Goodge Street are within half a mile of the apartment.

Features

- One Bedroom
- Central Location
- Fully Furnished
- Wooden Floors
- Spacious
- Modern

Ridgmount Street, London, WC1E

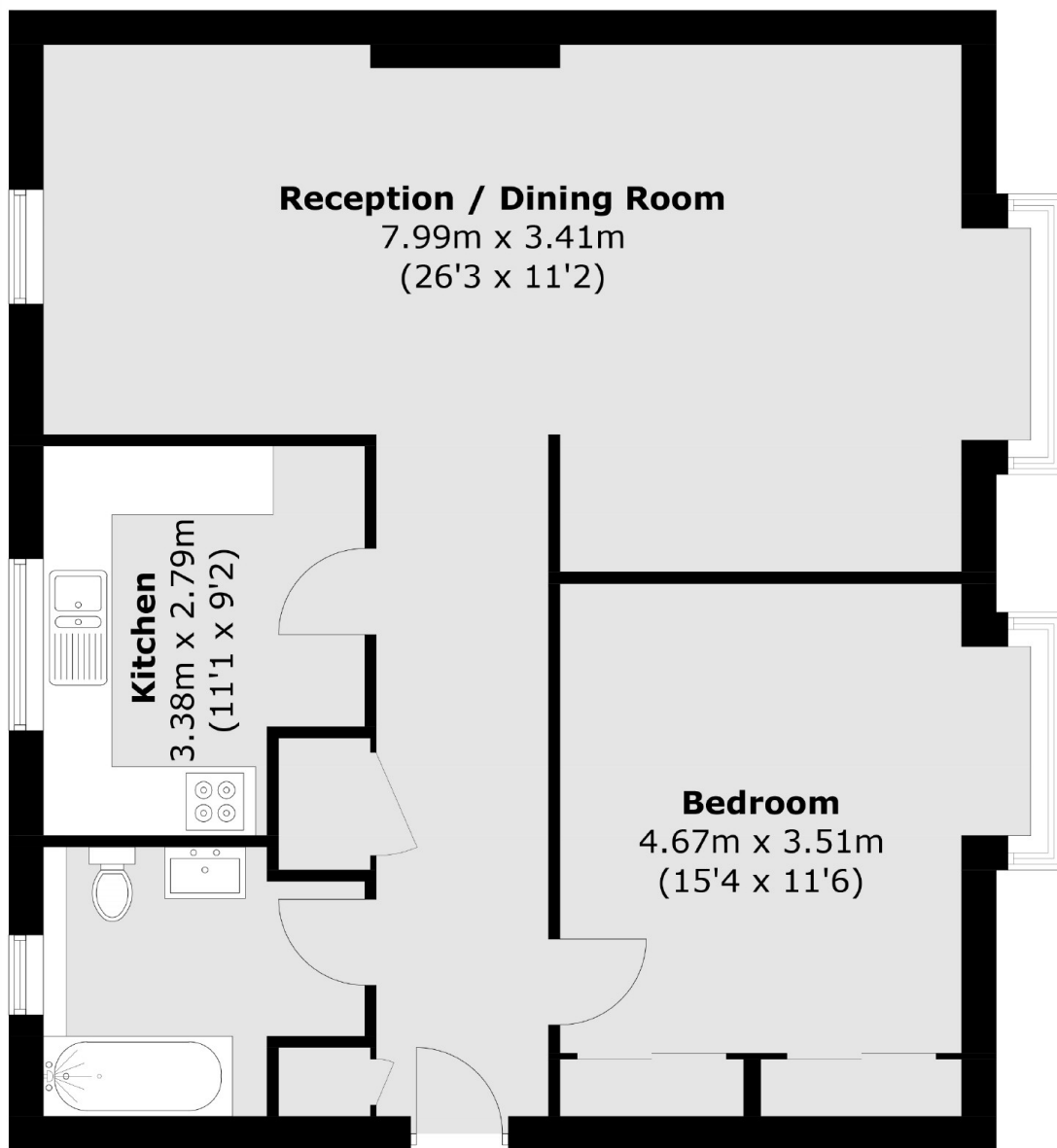

Total area (approx.): 76.5 sq. m (823.2 sq. ft)