



## Drury Lane, WC2B

£525 Per week

A newly refurbished one double bedroom apartment on the ground floor of a secure development in the heart of Covent Garden with wood floors throughout and separate storage unit.

Drury Lane is ideally located to all the shops, theatres and Restaurants of the West End with The Royal Opera House and Covent Garden Piazza within half a mile.

### Features

- Newly Refurbished
- Wood Floors
- Secure Development
- Built In Wardrobes
- Centrally Located
- Double Glazing

# Drury Lane, London, WC2B

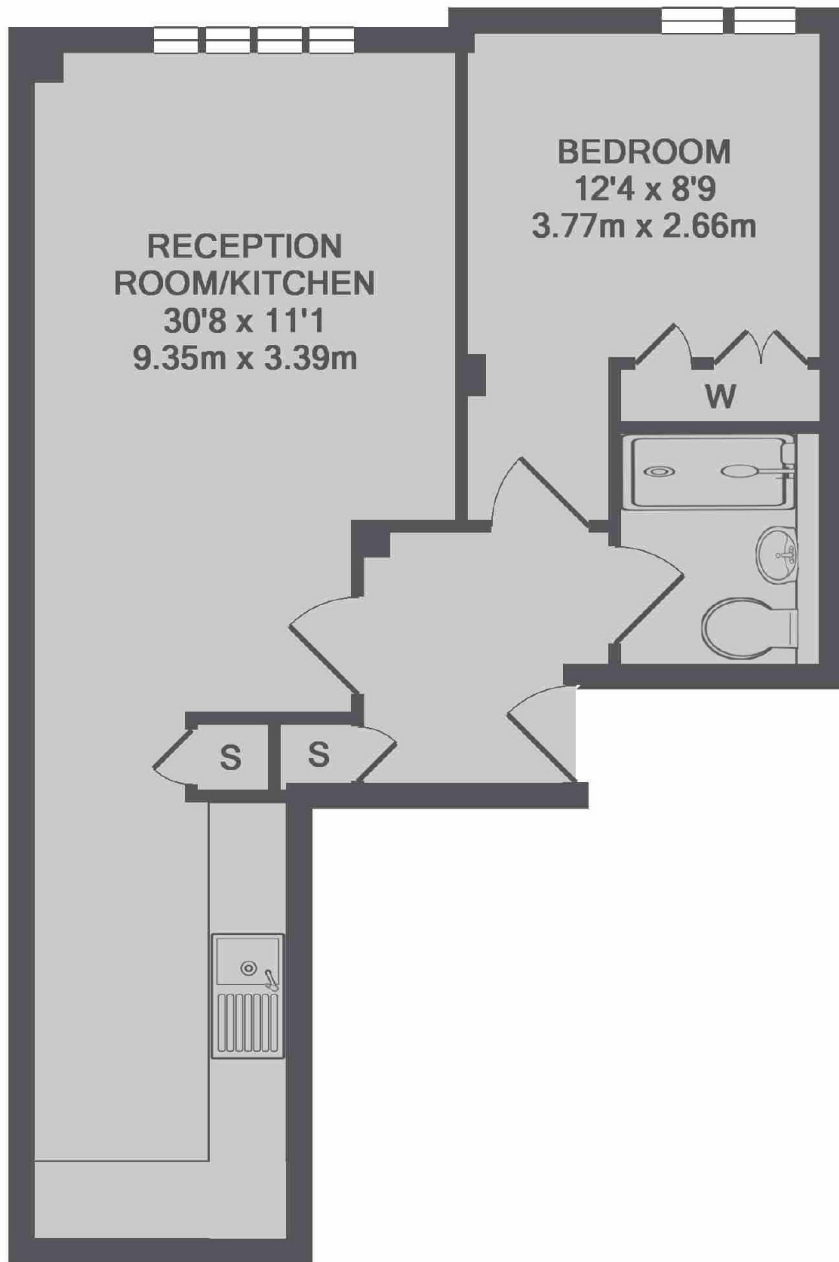

TOTAL APPROX. FLOOR AREA 458 SQ.FT. (42.6 SQ.M.)