



## Phoenix Street, WC2H

£1,050 Per week

This property boasts a capacious open-plan living room featuring a modern, well-equipped kitchen. Two generously sized bedrooms provide ample space for rest and relaxation. The apartment also has a balcony access from both the bedroom and living room, providing an excellent spot for enjoying fresh air and outdoor views.

Phoenix House boasts an ideal location with close proximity to a wide range of shops, bars, and restaurants in both Covent Garden and Soho. Additionally, Leicester Square and Tottenham Court Road tube stations are conveniently situated within a half-mile radius, providing easy access to the rest of the city.

### Features

- First Floor
- Open Plan Kitchen
- Prime Location
- Two Bedrooms
- Two Bathrooms
- Balcony
- Lift Access

# Phoenix Street, London, WC2H

## First Floor

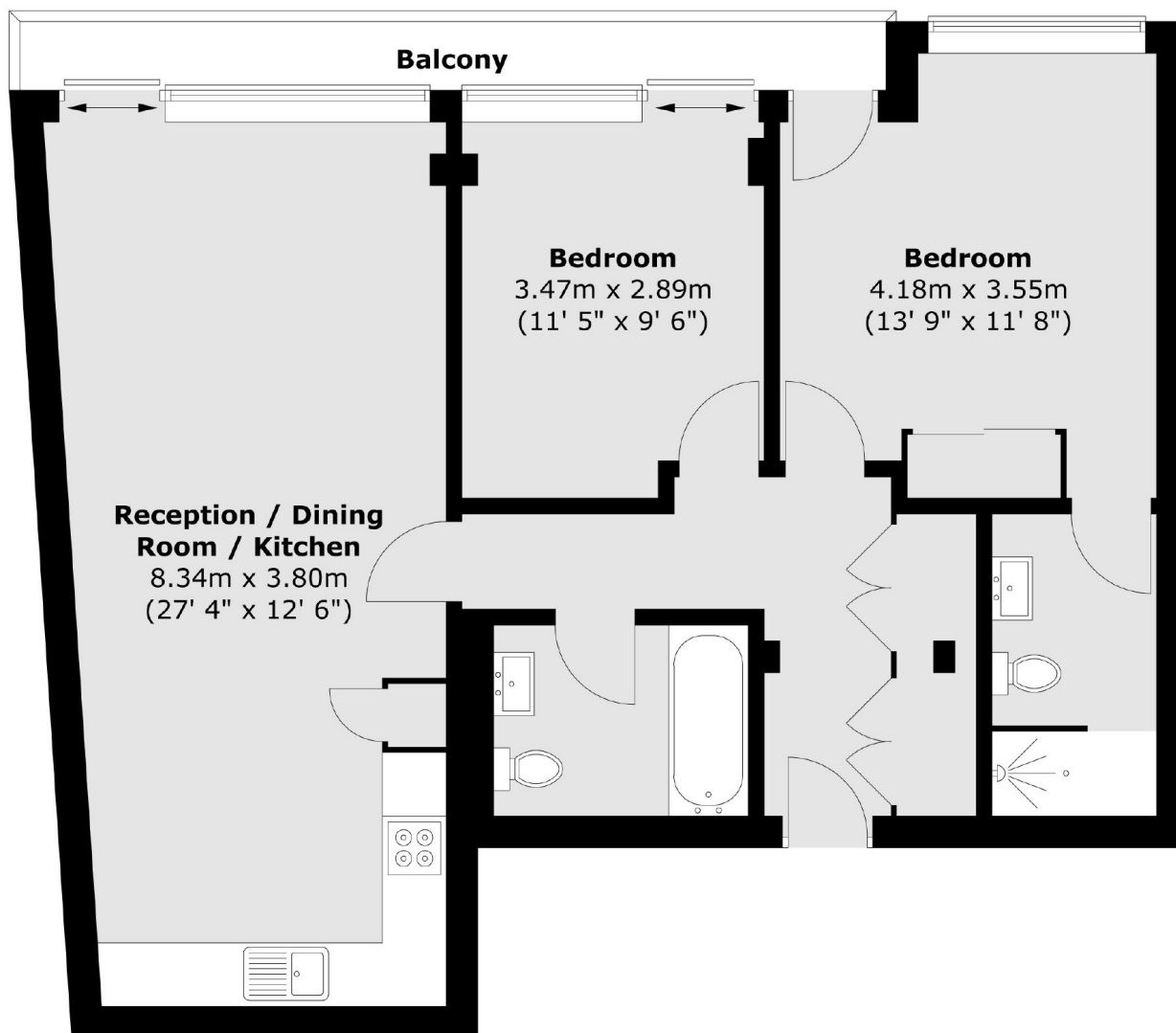

Total area (approx.) : 75.5 sq. m (813 sq. ft)  
Total balcony area (approx.) : 7.3 sq. m (78 sq. ft)