



## Red Lion Square, WC1R

£484 Per week

A beautifully decorated one double bedroom apartment within a Victorian mansion block in the heart of Holborn. The property has wooden floors throughout, a separate kitchen and communal Gardens

Red Lion Square is well located close to the shops and amenities of High Holborn and Covent Garden with Holborn and Chancery Lane station less than a quarter of a mile away.

### Features

- Wooden Floors
- One Double Bedroom
- Bay Window
- Mansion Block
- Good Transport Links
- Central Location

# Red Lion Square, London, WC1R

## Ground Floor

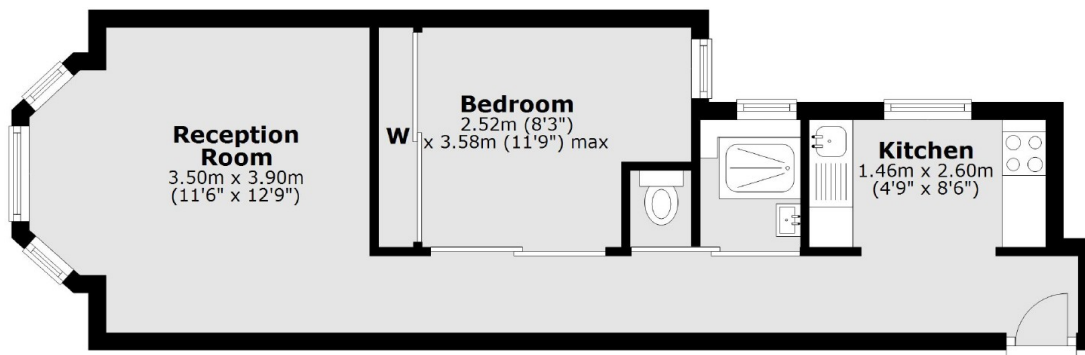

Total area: approx. 35.4 sq. metres (381.4 sq. feet)