



Soho Square, W1D

£750 Per week

Dexters



Soho Square, W1D

A rarely available and architecturally designed one bedroom top floor apartment within this prominent Grade II listed house on one of the West Ends rare and most sought after garden squares.

Situated on one of the few green open spaces in the Soho Conservation area, prominently stands No 15 Soho Square. This Grade II listed house is one of only two surviving original houses to the square and dates back to circa 1677.

Previously home to an eclectic mix of inhabitants including Lords, Earls and Countesses the house has now been painstakingly converted into four unique and luxurious apartments, consisting of two, one bedroom units, a two bedroom and a two/three bedroom duplex.

Each apartment has been meticulously and sympathetically designed to compliment the buildings rich past and seamlessly blends the many period features with today's latest contemporary materials and fixtures and fittings.

The house overlooks the square and is perfectly positioned for easy access to all the amenities the West End has to offer. It is well served for a wide array of transport links and is within 1km radius of Oxford Street, Covent Garden & Piccadilly Circus.

Features

- Grade II Listed
- Overlooking Square
- Central Position
- Exposed Beams
- Stripped Floors
- Loft Style



Soho Square, London, W1D

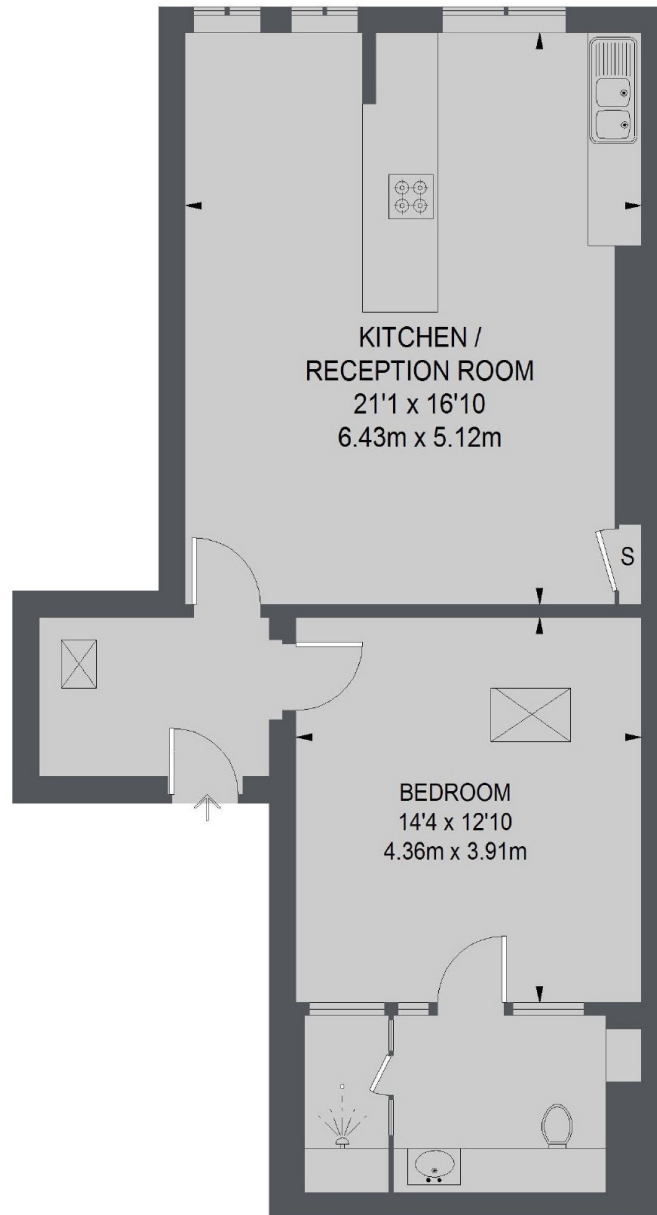

THIRD FLOOR

TOTAL APPROX. FLOOR AREA 696 SQ. FT. (64.73 SQ. M.)

Dexters

Fitzrovia & Covent Garden
66 Goodge Street
London
W1T 4NG
Lettings
020 7067 2402

Energy Rating: D. We aim to make our particulars both accurate and reliable. However they are not guaranteed; nor do they form part of an offer or contract. If you require clarification on any points then please contact us, especially if you're traveling some distance to view. Please note that appliances and heating systems have not been tested and therefore no warranties can be given as to their good working order.

 **RICS** | Regulated
Estate Agent
and Letting Agent

dexters.co.uk