



Poppins Court, EC4A

£519 Per week

A modern and bright one double bedroom flat on the first floor of a modern secure development with lift access and wood floors throughout just off Fleet Street.

Poppins Court is ideally located between Fleet Street and St Bride Street moments from the City Thames link, Blackfriars Station and the river Thames.

Features

- Furnished
- Wood Floors Throughout
- Modern Bathroom
- Secure Development
- Centrally Located
- Bright

Poppins Court, London, EC4A

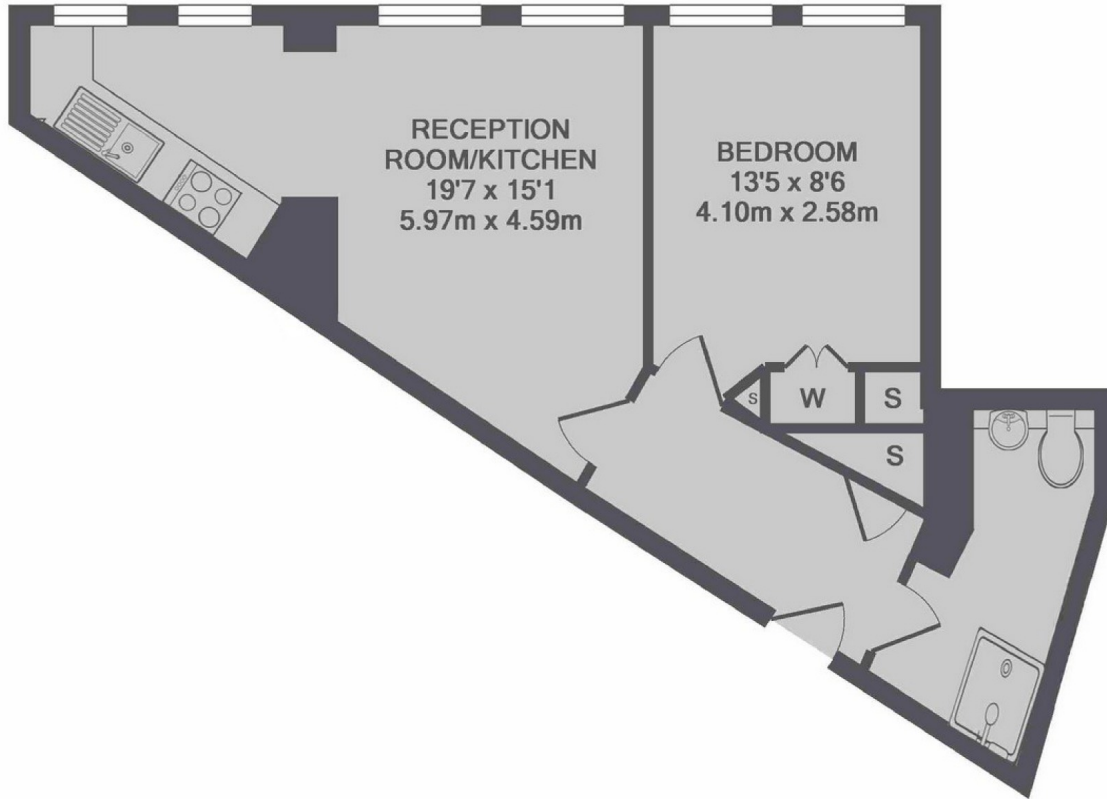

TOTAL APPROX. FLOOR AREA 411 SQ.FT. (38.2 SQ.M.)