



Conway Street, W1T

£710,000

A bright one bedroom apartment arranged over the ground and raised ground floors around a private courtyard garden. The period home has a share of freehold and is offered chain free.

Located just off Fitzroy Square. Accessible to the restaurants, world-class amenities and retail of London's West End. Local transport links are Warren Street, Great Portland Street and Tottenham Court Road.

Features

- Bedroom
- Reception Room
- Share of Freehold
- Courtyard
- Low Service Charge
- Chain Free

Conway Street, London, W1T

Conway Street, W1T 6BW

Approx. 590 sq. feet (54.81 sq. metres)

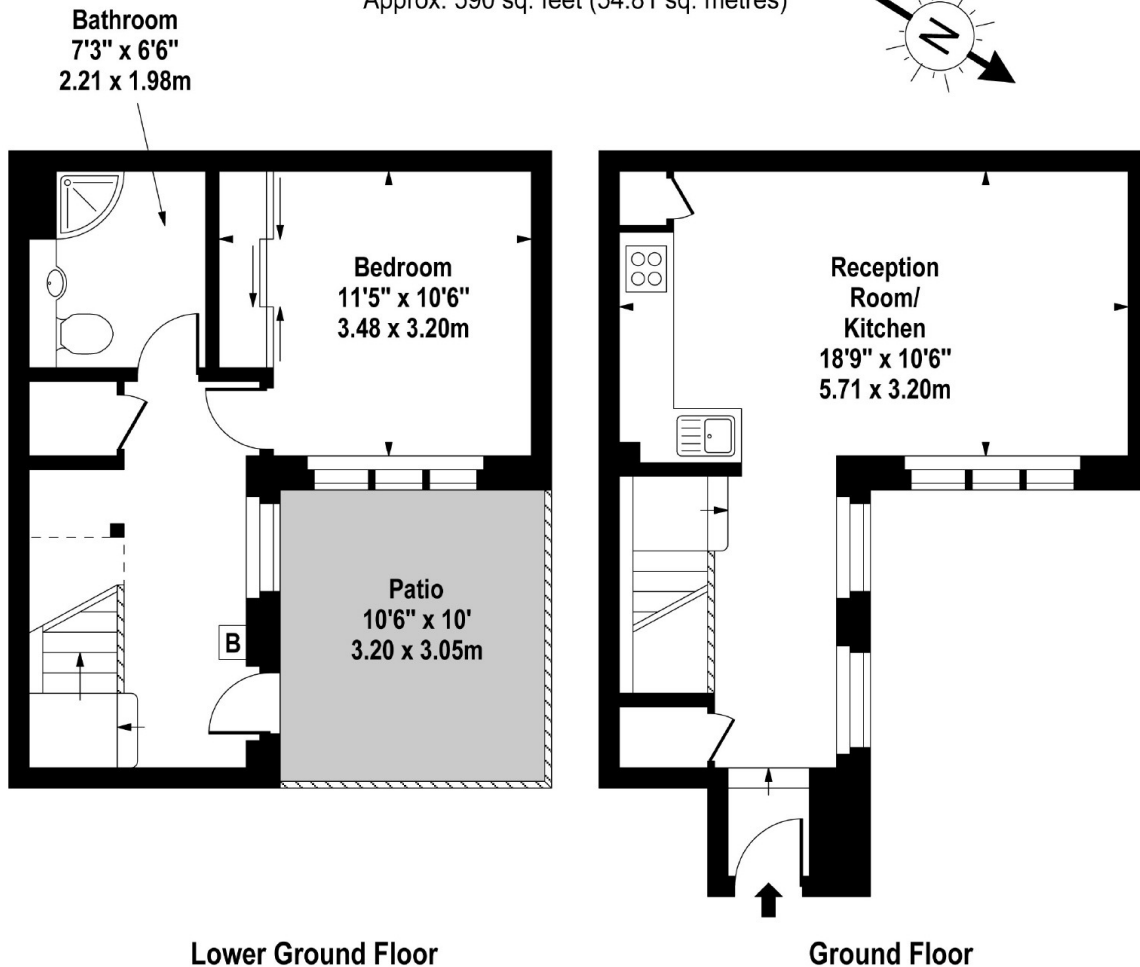
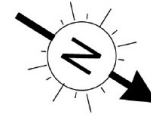

For Illustration Purposes Only - Not To Scale
www.goldlens.co.uk
Ref. No. 008389J