



Bradgate Close, Cuffley



- FIVE SPACIOUS DOUBLE BEDROOMS
- 3 RECEPTION ROOMS
- SUPER ROOM
- CUL-DE-SAC LOCATION
- PRIVATE ROAD OF ONLY 11 HOMES
- 3 BATHROOMS
- PLENTY OF OFF STREET PARKING
- SOUTH EAST FACING GARDEN



Bradgate Close
Cuffley EN6 4RF

Set in a quiet cul-de-sac just off prestigious Hanyards Lane, this beautifully presented five-bedroom family home offers over 3,000 square feet of accommodation on a private road of just 11 homes. The welcoming entrance hallway leads to a thoughtfully designed layout, with the stunning super room seamlessly integrating the kitchen, living, and dining areas. Bathed in natural light, this space features sleek two-tone cabinetry, Quartz worktops, integrated appliances, and a central island, creating an ideal setting for everyday living and entertaining. Additional ground-floor spaces include a formal living room, dining room, study, large laundry room, utility room, and cloakroom. Upstairs, five well-appointed bedrooms provide ample space for family and guests. The luxurious master suite boasts a dressing room and spa-like en-suite bathroom, while the guest bedroom also benefits from an en-suite shower room. A stylish family bathroom serves the remaining bedrooms. The south-facing garden is a private oasis with a block-paved patio and a well-maintained lawn with side access, perfect for outdoor gatherings. Approximately one mile from Cuffley village, this home enjoys excellent transport links, with direct train routes to London’s Finsbury Park, and Moorgate. Families will appreciate the variety of nearby schools, while Northaw Great Woods and Cuffley Lawn Tennis Club offer fantastic recreational options close to home.

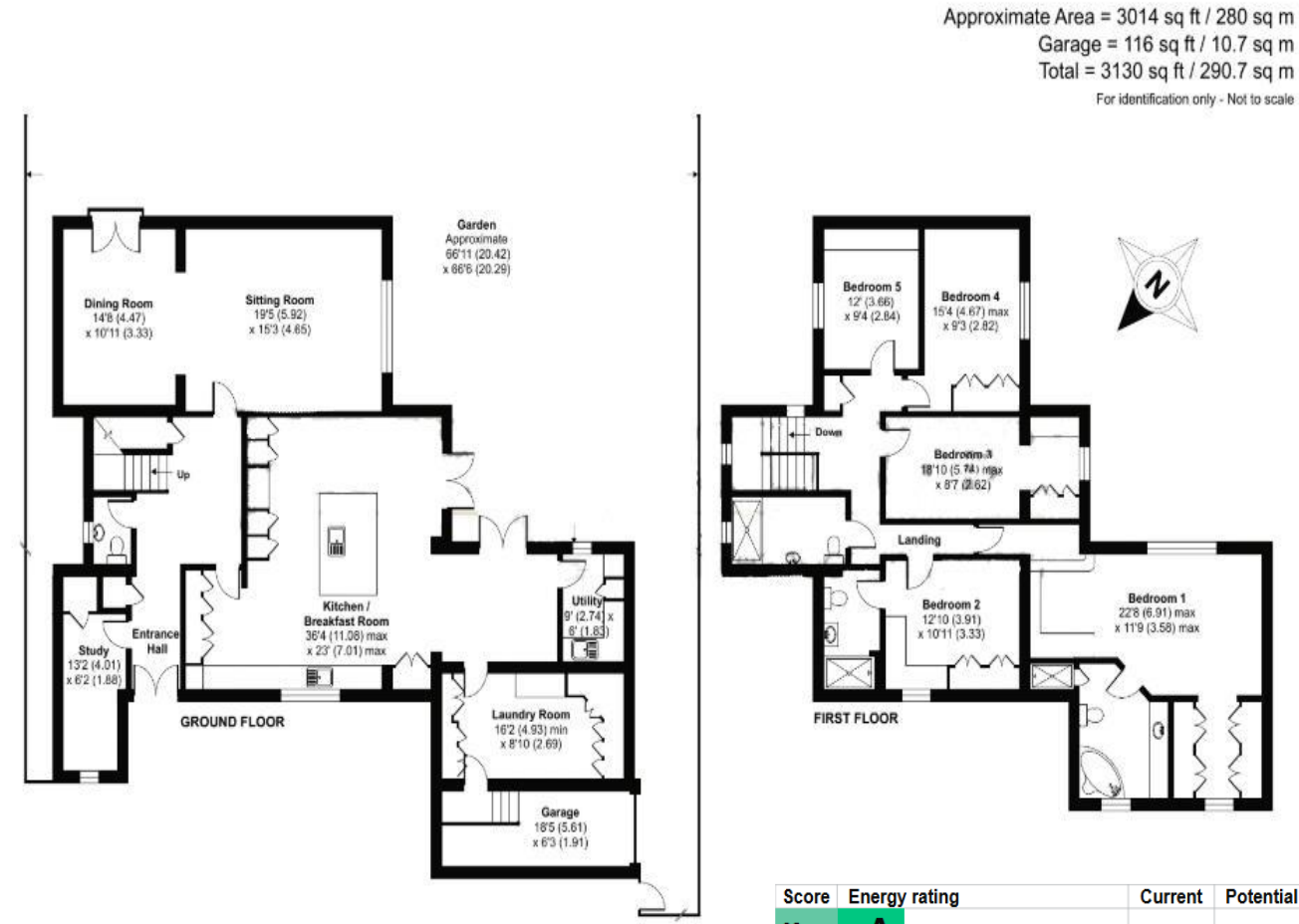

Certified Property Measurer
Floor plan produced in accordance with RICS Property Measurement Standards incorporating International Property Measurement Standards (IPMS2 Residential). © ritchcom 2022. Produced for Fino & Country. REF: 831066

Score	Energy rating	Current	Potential
92+	A		
81-91	B		82 B
69-80	C	79 C	
55-68	D		
39-54	E		
21-38	F		
1-20	G		