



Gravel Hill, Coventry, CV4 9JR

**SHELDON
BOSLEY
KNIGHT**

LAND AND
PROPERTY
PROFESSIONALS

Property Description

Attention investors, this one bedroom first-floor flat, situated in the Tile Hill area, is being offered for sale with a tenant in-situ. The property comprises of an entrance hall, living room, separate kitchen, bathroom and one double bedroom.

Outside, the property benefits from a private balcony with access through the living room. Ideal for property investment, the abode is currently achieving a rental amount of £625pcm with a potential rental yield of 7.5%.





Key Features

- First Floor Flat
- No Chain
- Ideal Investment or First Time Purchase Opportunity
- Private Balcony
- Rental Yield of 7.5%

£100,000



First Floor

Approx. 45.8 sq. metres (493.0 sq. feet)

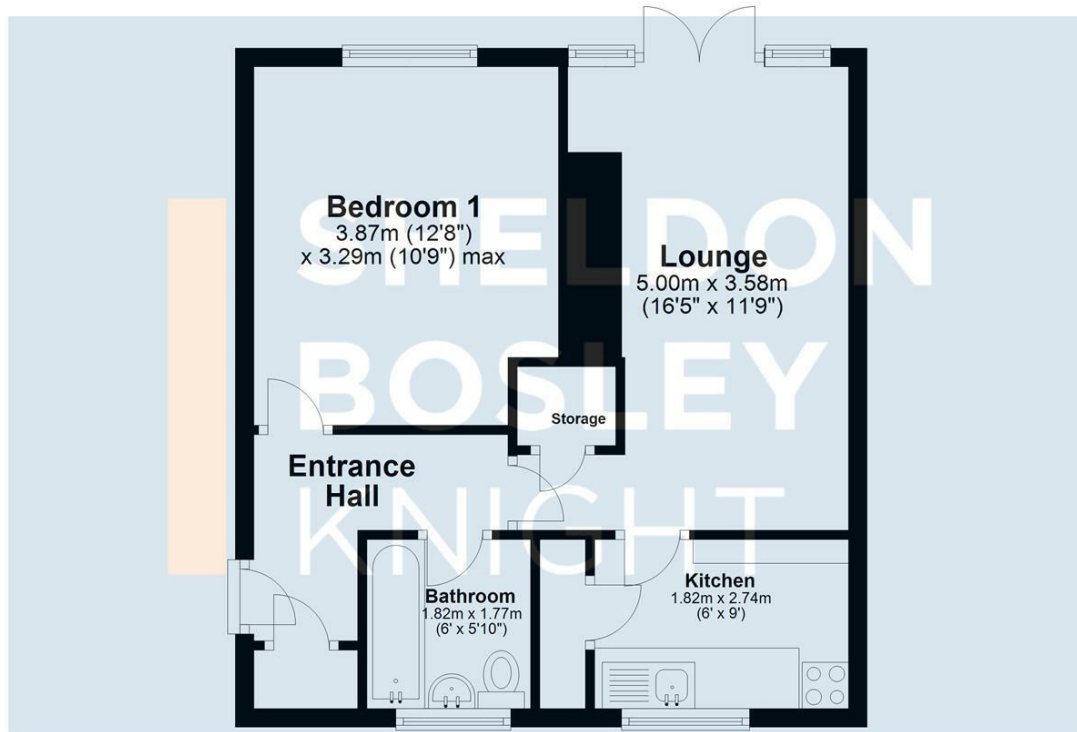

Total area: approx. 45.8 sq. metres (493.0 sq. feet)

All efforts have been made to ensure that the measurements on this floorplan are accurate however these are for guidance purposes only.
Plan produced using PlanUp.



EPC Rating - C

Tenure - Leasehold

Council Tax Band - A

Local Authority
Coventry



We routinely refer clients to both our recommended legal firm and a panel of financial services providers. It is your decision whether you choose to deal with these companies. In making that decision, you should know that we receive a referral fee.

**SHELDON
BOSLEY
KNIGHT**

LAND AND
PROPERTY
PROFESSIONALS