



**Bartleet Mews, Birmingham Road, Bromsgrove, B61 0DJ**

**SHELDON  
BOSLEY  
KNIGHT**

LAND AND  
PROPERTY  
PROFESSIONALS

# Property Description

Bartleet House is an attractive Grade II listed building dating back to 1838. Once a hospital, the former commercial building has undergone a residential conversion for nine spacious apartments.

Next to this imposing red brick property is a row of three terrace houses, newly build in the same style to the main building, and are also set back from the gated access with off road parking and EV charging points to the front.

Internally, the houses are spoilt with natural light and all have open plan living giving a great sense of space as you walk in. Each property is finished with light grey carpets to bedrooms and living rooms while the more modern gloss style kitchens complement the colour scheme with a deeper grey and off white granite work tops. All kitchens are complimented with a central island and Klarstein extractor over top, Lamona appliances including electric hobs and oven, dishwasher, build in fridge freezer, and washer dryers. All mews properties have video entry system wall panels for gate control. There is no gas to the properties.

Bartleet House is situated in Bromsgrove and is only a short walk from the town centre. The property is also only 1 mile to the M42 motorway access. Bromsgrove is a town in Worcestershire, England, about 16 miles northeast of Worcester and 13 miles southwest of Birmingham city centre. Surrounded by beautiful rolling countryside and a wide range of places to visit and things to see and do, Bromsgrove offers great food and drink, real ale pubs, canal restaurants, town centre bistros and cafes and country pubs.





## Key Features

- Part Of Bartleet House Conversion
- Open Plan Living With Kitchen Island Feature
- Two Double Bedrooms
- Lamona Appliances Throughout
- Two Allocated Parking Spaces With EV Charging Points
- Secure Gated Access With Modern Intercom
- Bromsgrove Town Centre Location
- Great M42 Motorway Access
- Lawned Rear Gardens



### Ground Floor

Approx. 30.5 sq. metres (328.4 sq. feet)



### First Floor

Approx. 30.5 sq. metres (328.4 sq. feet)

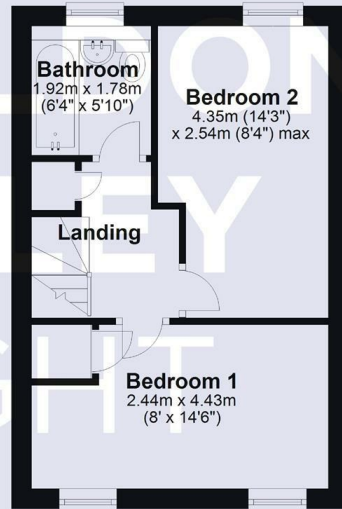

Total area: approx. 61.0 sq. metres (656.9 sq. feet)

DISCLAIMER - Floor plans shown are for general guidance only. Whilst every attempt has been made to ensure that the floorplan measurements are as accurate as possible, they are for illustrative purposes only.

### Ground Floor

Approx. 30.5 sq. metres (328.4 sq. feet)



### First Floor

Approx. 30.5 sq. metres (328.4 sq. feet)

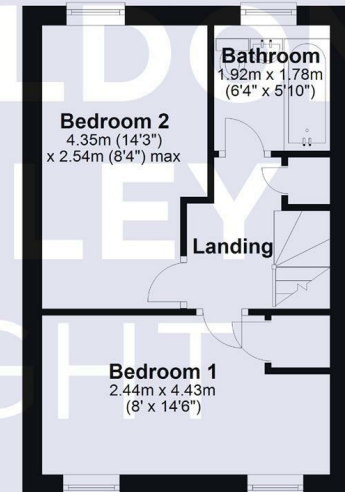

Total area: approx. 61.0 sq. metres (656.9 sq. feet)

DISCLAIMER - Floor plans shown are for general guidance only. Whilst every attempt has been made to ensure that the floorplan measurements are as accurate as possible, they are for illustrative purposes only.

Tenure - Freehold

Council Tax Band - New Build

Local Authority  
Bromsgrove District Council

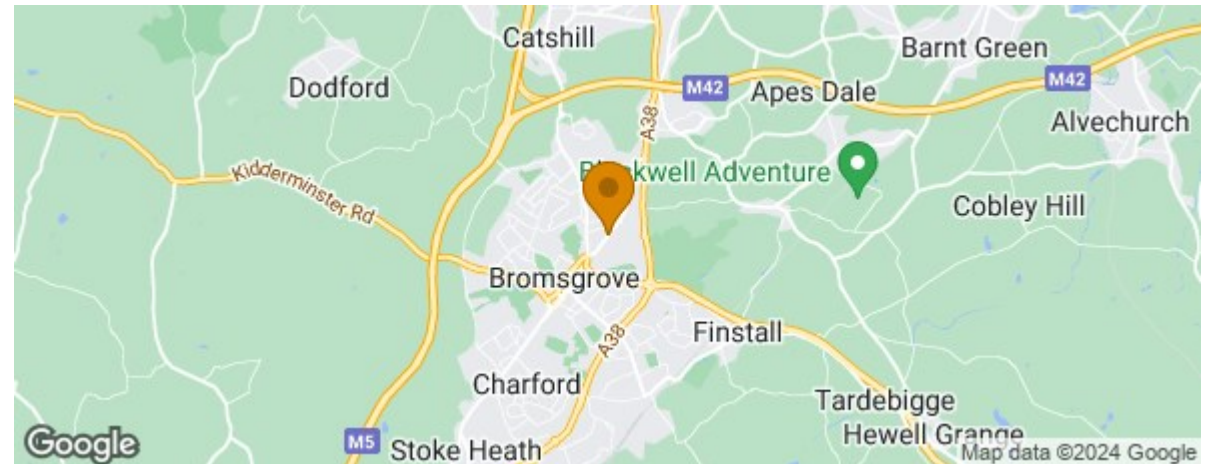

# Our Testimonials

Excellent sales team. Chloe, Christian and Leanne supported me throughout a difficult sale and at a very competitive fee. They really know their stuff and I wouldn't hesitate to recommend SBK Evesham. Thank you!

Louise Orchard

Fantastic and easy experience. Nothing was too much to ask and the team were incredible in providing support and reassurance in our first move. Everything was communicated to us professionally and efficiently. Massive thanks to the team for making this move possible.

Anna Stoumann

We found our dream home and needed to sell our house to make an offer. Andrew and the team at Sheldon Bosley knight Leamington were fantastic. They managed to value our home, got photos and floor plans sorted, advertised, completed viewings and we had an above asking price offer accepted in one and a half weeks from first contacting them!! Communication from both Andrew, Sophie and the team plus through their online portal was great throughout. Honestly couldn't have asked for more.

Charlie Foley

Both Amy and Amelia were incredibly helpful and proactive throughout the purchase of our property. The commitment that they both showed to the sellers and us as buyers was second to none and meant that any moving bumps were successfully managed. We would wholeheartedly recommend them to friends and, if we were to consider moving again, would certainly use them.

Emmah Ferguson

I had a great experience while purchasing a house with Sheldon Bosley Shipston on stour. From start to finish they have done everything they can to help and been great with communication. I dealt with Kate and Morgan who were both lovely but I'm sure it was a team effort behind the scenes. I felt like they were there for me and supportive. Thank you to you all!

Georgie Smith

Very helpful and friendly staff. They were happy to provide names of local tradesmen which will be a great help. Would highly recommend.

Jane Harms

A stress free procedure due mainly to the estate agent Rockwell Allen. There was excellent communication and marketing with the bonus of getting the asking price.

Susan

Millie has been absolutely brilliant from the word go. The whole experience has been a breath of fresh air and the complete opposite from our last dealings with an estate agent. Thank you Millie for all your hard work and advice, couldn't be bettered.

Kate

We couldn't recommend Sheldon Bosley Knight more. After having a house sale fall through previously, we were very nervous about making our offer, but the lovely Annette and Sara guided us through everything with ease and made us feel so comfortable with our decisions. We got the house of our dreams, and we are absolutely delighted! They made us feel like friends and we would recommend them to anyone looking to buy their perfect home.

Jen Singleton

To book a free no obligation market appraisal of your property contact your local office.

[sheldonbosleyknight.co.uk](http://sheldonbosleyknight.co.uk)



SALES

LETTINGS

PLANNING &  
ARCHITECTURE

COMMERCIAL

STRATEGIC  
LAND

NEW  
HOMES

BLOCK  
MANAGEMENT

RURAL



DISCLAIMER

All fixtures and fittings mentioned in these particulars are included in the sale, all others in the property are specifically excluded. Photographs are reproduced for general information and it must not be inferred that any item is included for sale with the property. These particulars are thought to be materially correct. Their accuracy is not guaranteed and they do not form part of any contract.