



PCM

£3,300 PCM

Lyndhurst Way

, SE15 4PT

**GARETH
JAMES**

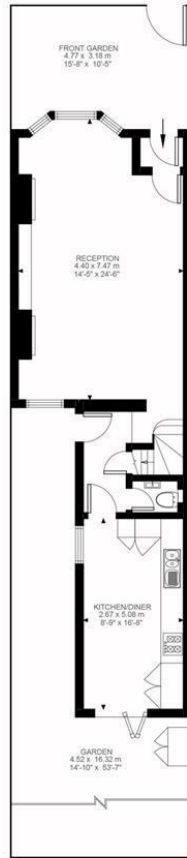

Ground Floor
577 ft²



First Floor
595 ft²

Lyndhurst Way, SE15
Approximate Gross Internal Area
108.86 SQ.M / 1172 SQ.FT



Illustration for identification purposes only. Not to scale.
Floor Plan Drawn According To RICS Guidelines.

3

1

0

Energy Efficiency Rating		Current	Potential
Very energy efficient - lower running costs			
(92 plus) A			
(81-91) B			
(69-80) C			
(55-68) D			
(39-54) E			
(21-38) F			
(1-20) G			
Not energy efficient - higher running costs			
England & Wales			
		47	70
		EU Directive 2002/91/EC	



Agents Note: Whilst every care has been taken to prepare these particulars, they are for guidance purposes only. All measurements are approximate and are for general guidance purposes only and whilst every care has been taken to ensure their accuracy, they should not be relied upon and potential buyers/tenants are advised to recheck the measurements

**GARETH
JAMES**

OFFICE ADDRESS
129 Bellenden Road
London
SE15 4QY

OFFICE DETAILS
02077324330
lettings@garethjames.com
<https://www.garethjames.com/>