

# The Floorplan...

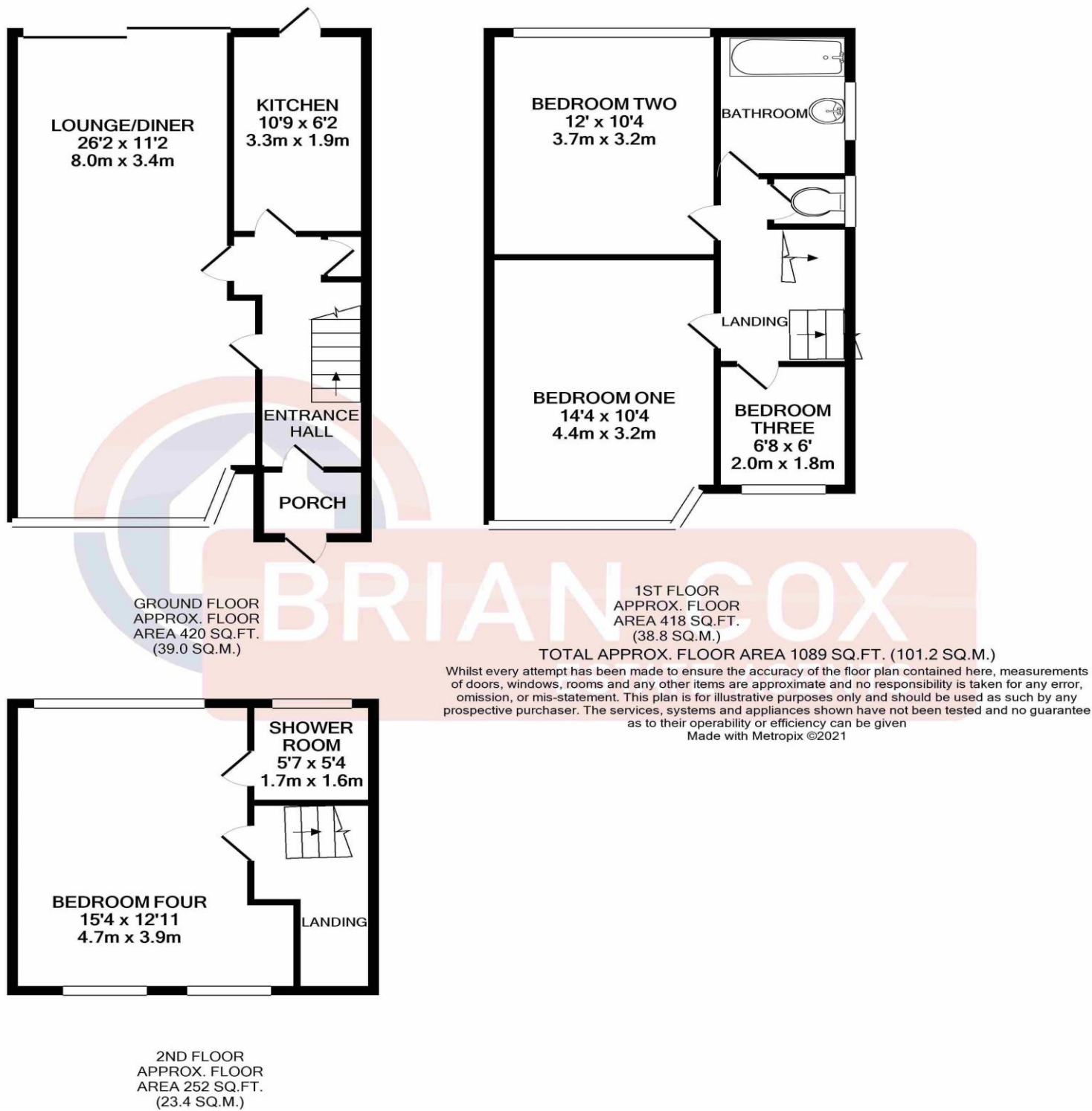

## More Details From...

Call: **Brian Cox North Harrow: 020 3866 6640**  
 Email: **Azi.Rahman@brian-cox.co.uk**  
 Web: **www.brian-cox.co.uk**



Consumer Protection from Unfair Trading Regulations 2008 We have not tested any apparatus, equipment, fixtures, fittings or services and so cannot verify that they are in working order or fit for purpose. You are advised to obtain verification from your solicitor or surveyor. References to the tenure of a property are based on information supplied by the seller. We have not had sight of the title documents and a buyer is advised to obtain verification from their solicitor. Items shown in photographs are not included unless specifically mentioned within the sales particulars, but may be available by separate negotiation. We advise you to book an appointment to view before embarking on any journey to see a property, and check its availability.



0203 866 6640  
 brian-cox.co.uk



This well presented five bedroom, two bathroom semi detached property enters the market with Brian Cox Estate Agents. The property is situated close to shopping facilities, sought after schools and transportation links. Accommodation: entrance hallway, spacious lounge/dining room, attractive fitted kitchen, four good sized bedrooms, en suite shower room and family bathroom. Further benefits include gas central heating, double glazing and a delightful 70ft rear garden.



Monthly Rental Of £2,695  
 Freehold

Twyford Road, Harrow HA2 0SL





## In Brief...

- Five Good Sized Bedrooms
- Two Bathrooms
- Well Presented Accommodation
- Sought After Location
- Available furnished or unfurnished
- Spacious & large family Home
- Great Schools



## The Location...

### Nearest Stations ...

Rayners Lane (0.4 miles)  
West Harrow (0.6 miles)  
South Harrow (0.8 miles)



West Harrow is located on the western side of the London Borough of Harrow, and roughly halfway between the north and south boundaries of the borough. To the south east of West Harrow is Harrow on the Hill, to its north east is Greenhill, to its west is Rayners Lane, to its north is North Harrow, and to its south are Roxeth and South Harrow. The construction of the Uxbridge extension to the Metropolitan line in 1904, and specifically the new West Harrow tube station, triggered a steady growth of homes in the area, spreading out from the location of the new station.

