

27 Elizabeth Street
Thornaby
Stockton-On-Tees
TS17 7DH



IH INGLEBY HOMES





27 Elizabeth Street
£550 PCM



Local Authority

Council Tax Band

A

Directions

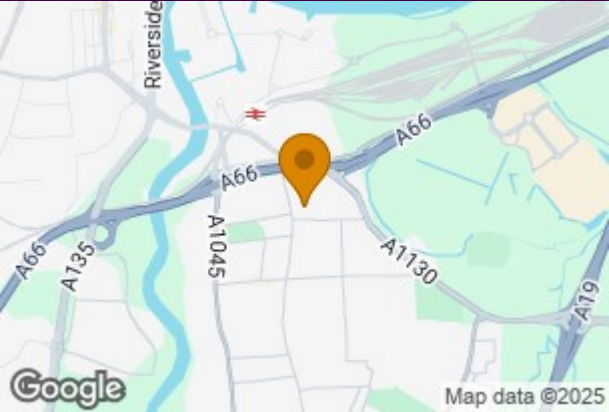
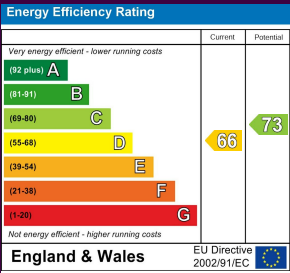

Agents Note: Whilst every care has been taken to prepare these particulars, they are for guidance purposes only. All measurements are approximate and are for general guidance purposes only and whilst every care has been taken to ensure their accuracy, they should not be relied upon and potential buyers/tenants are advised to recheck the measurements

GROUND FLOOR
392 sq.ft. (36.4 sq.m.) approx.

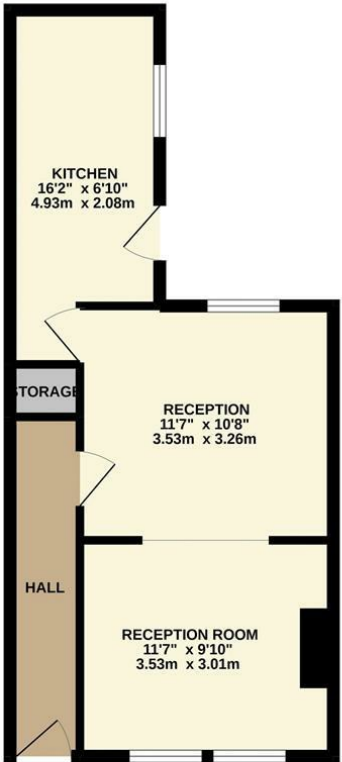

1ST FLOOR
348 sq.ft. (32.3 sq.m.) approx.



Ingleby Homes
6 Halegrove Court
Stockton On Tees
TS18 3DB

Contact

01642 671025

karen@ingleby-homes.co.uk

<https://www.ingleby-homes.co.uk/>

IH INGLEBY HOMES