

# Hatchlands Park, Ingleby Barwick

TS17 5GT



£162,500

- Accommodation delivered over three levels
- Three double bedrooms
- Off-road parking, and enclosed rear garden
- Popular 'Simonside' design by Persimmon
- Ideal for schooling and amenities



# Home, Changes Everything





This modern, three double bedroom property delivers deceptively spacious accommodation over three levels and certainly merits early inspection.



Located within this popular 'Broom Hill' area of Ingleby Barwick, perfect for local schooling, and fantastic amenities which are only a stroll away. Enjoying off-road parking for two cars to the front, and an enclosed rear garden which is low maintenance.



Cared for, well-appointed and attractive, the internal accommodation briefly comprises an entrance hall, lounge, inner hall, cloakroom/WC and kitchen/diner to the ground floor. The first floor brings two of the double bedrooms, one with fitted robes, along with the smart family bathroom. The third double bedroom occupies the second floor, and benefits from a generous, walk-in robe/closet.





# The Layout

GROUND FLOOR

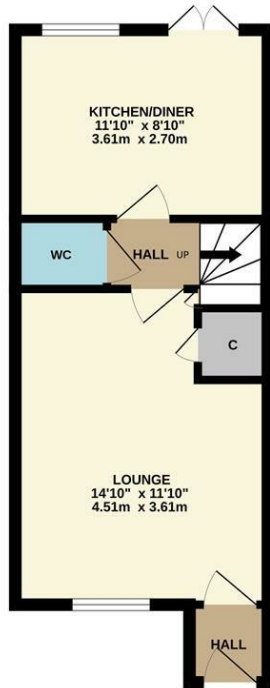

1ST FLOOR

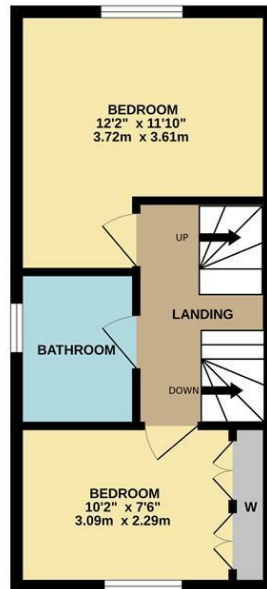

2ND FLOOR

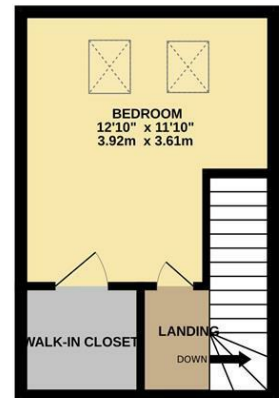

Whilst every attempt has been made to ensure the accuracy of the floorplan contained here, measurements of doors, windows, rooms and any other items are approximate and no responsibility is taken for any error, omission or mis-statement. This plan is for illustrative purposes only and should be used as such by any prospective purchaser. The services, systems and appliances shown have not been tested and no guarantee as to their operability or efficiency can be given.  
Made with Metropix ©2025

# The Location



# Home, Changes Everything



# Hatchlands Park

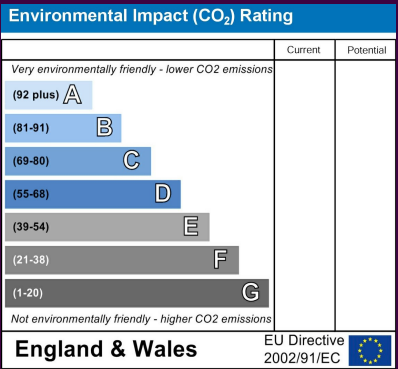
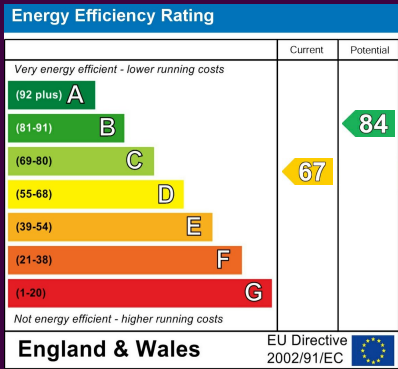

Council Tax Band: C  
Tenure: Freehold

[www.ingleby-homes.co.uk](http://www.ingleby-homes.co.uk)

Tel: 01642 671025

Email: [sales@ingleby-homes.co.uk](mailto:sales@ingleby-homes.co.uk)