

13 Verbeia Road
Ingleby Barwick
Stockton-On-Tees
TS17 5FT



IH INGLEBY HOMES



13 Verbeia Road
£850 PCM



Local Authority

Council Tax Band

C

Directions

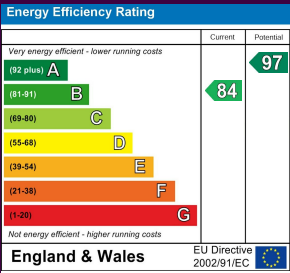

Agents Note: Whilst every care has been taken to prepare these particulars, they are for guidance purposes only. All measurements are approximate and are for general guidance purposes only and whilst every care has been taken to ensure their accuracy, they should not be relied upon and potential buyers/tenants are advised to recheck the measurements

GROUND FLOOR
380 sq.ft. (35.3 sq.m.) approx.

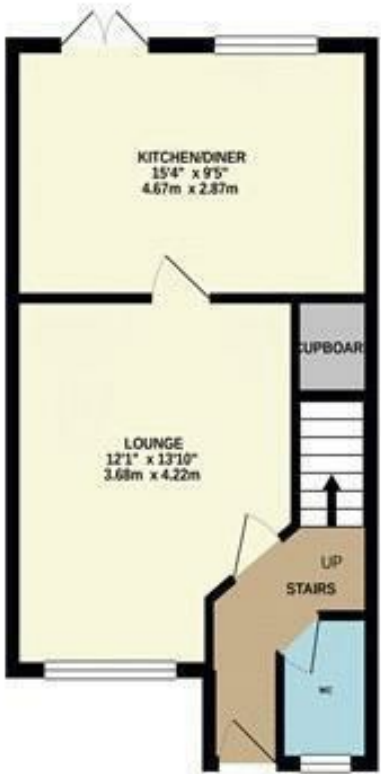

1ST FLOOR
354 sq.ft. (32.9 sq.m.) approx.



TOTAL FLOOR AREA - 735 sq.ft. (68.3 sq.m.) approx.

While every attempt has been made to ensure the accuracy of the floorplan contained herein, measurements of doors, windows, rooms and any other items are approximate and no responsibility is taken for any errors, omissions or misstatements. This plan is for illustrative purposes only and should be used as a guide only for any prospective purchaser. The services, systems and appliances shown have not been tested and no guarantee as to their operating or efficiency can be given.
Made with Hoxign 7/2025

Ingleby Homes
6 Halegrove Court
Stockton On Tees
TS18 3DB

Contact

01642 671025

karen@ingleby-homes.co.uk

www.ingleby-homes.co.uk

IH INGLEBY HOMES