

Coleus Close



BRAND NEW and available for IMMEDIATE LET

£1,150

Miller Built, three storey property within Becksde Manor

Impressive throughout with new floorings and decor

Superb kitchen, bathroom and ensuite

Fabulous 'Master' suite occupies second floor





BRAND NEW and available for **IMMEDIATE LET** - It may prove essential to act quickly when it come to this impressive, 'Miller' built property that delivers attractive accommodation over three levels. 'Turn Key' ready, with new floorings and decor throughout, whilst the fantastic second floor 'Master Suite' and terrific kitchen with built in fridge/freezer and oven, are note worthy features.

The rear garden will be freshly turfed for an occupier, and the landlord is to include a regular garden maintenance service within the tenancy. Located on the popular 'Beckside Manor' development of Ingleby Barwick, and enjoying a double width, block-paved front drive, with enclosed rear garden. Internally, the smart accommodation comprises an entrance hall, lounge, impressive kitchen/diner, and cloakroom/WC to the ground floor. The first floor delivers two bedrooms, and the modern family bathroom, whilst the afore mentioned 'Master' of double bedroom and ensuite occupies the second floor.

GROUND FLOOR
301 sq.ft. (28.0 sq.m.) approx.

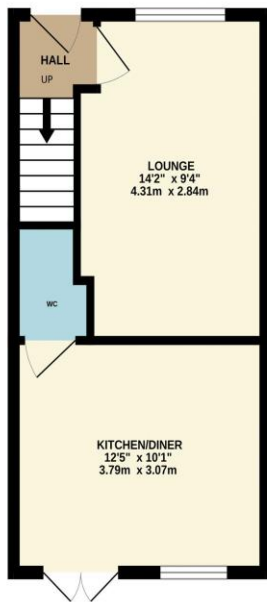

1ST FLOOR
301 sq.ft. (28.0 sq.m.) approx.

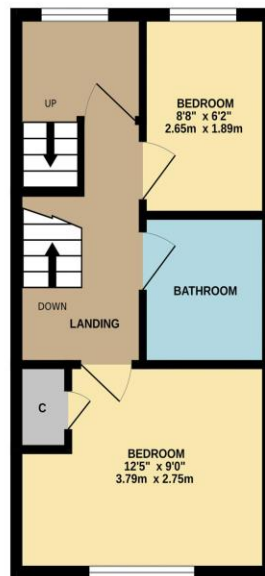

2ND FLOOR
224 sq.ft. (20.8 sq.m.) approx.

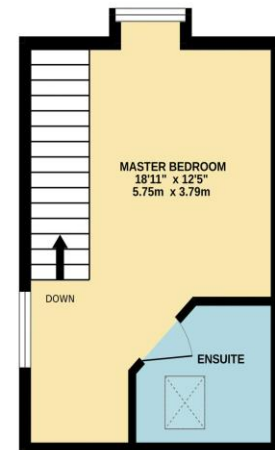

TOTAL FLOOR AREA : 827 sq.ft. (76.8 sq.m.) approx.

Whilst every attempt has been made to ensure the accuracy of the floorplan contained here, measurements of doors, windows, rooms and any other items are approximate and no responsibility is taken for any error, omission or mis-statement. This plan is for illustrative purposes only and should be used as such by any prospective purchaser. The services, systems and appliances shown have not been tested and no guarantee as to their operability or efficiency can be given.
Made with Metropix 62024



“The Ingleby Barwick Experts”



Tenure: Freehold

Council Tax Band: C

EPC Rating: B



AGENTS NOTE: Every care has been taken with the preparation of these details, but they are for general guidance only. Measurements and dimensions are approximate, and any fixtures or fittings shown in photography does not infer that they are to be included within the sale. The agent has not tested any appliances or supplies and professional verification of these should be sought prior to purchase if required. These particulars do not constitute a contract or part of a contract.