

The Rings



Built to the popular 'Rufford' design by Persimmon

Spacious and modern accommodation

Attractive position, tucked back from 'The Rings Road'

Surprisingly generous rear garden, extended parking and garage

Three good bedrooms, 'Master' with ensuite

£189,995



Multi-Award Wining

A great example of its kind, and sitting in a lovely position tucked back from 'The Rings Road' - with extended parking, integral garage and surprisingly generous rear garden. Built to the very popular 'Rufford' design by Persimmon and well presented throughout, internal inspection is certainly recommended.

Deceptively spacious and modern throughout, the accommodation briefly comprises an entrance hall, lounge, inner-hall, cloakroom/WC and open-plan kitchen/diner to the ground floor. The first floor delivers three good bedrooms, 'Master' with ensuite, and separate family bathroom.

GROUND FLOOR

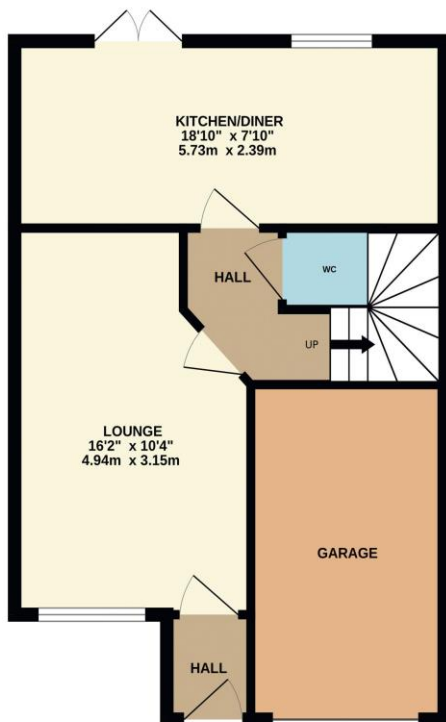

1ST FLOOR



“The Ingleby Barwick Experts”





Tenure: Freehold

Council Tax Band: D

EPC Rating: B



AGENTS NOTE: Every care has been taken with the preparation of these details, but they are for general guidance only. Measurements and dimensions are approximate, and any fixtures or fittings shown in photography does not infer that they are to be included within the sale. The agent has not tested any appliances or supplies and professional verification of these should be sought prior to purchase if required. These particulars do not constitute a contract or part of a contract.