

Brendon Grove



Desirable Sober Hall location within Ingleby Barwick

Much upgraded, remodelled and extended

Stunning refitted kitchen/diner

Enviably corner plot with southerly gardens

Available with no forward chain

£330,000



Multi-Award Wining



This handsome, double fronted, four bedroom property is located within this very desirable Sober Hall area of Ingleby Barwick, whilst boasting wrap-around front and side gardens, a re-laid drive and garage. Much upgraded and extended, with features such as the superb refitted kitchen/diner, garden room and refitted bathrooms being features worthy of special mention.

Very briefly, the spacious, remodelled accommodation comprises an entrance hall, full depth and bay-fronted living room, impressive garden room with bi-fold and vaulted ceiling, cloakroom/WC and stunning refitted kitchen/diner with a range of integrated appliances, including triple built-in ovens and quality surfaces on the ground floor. The first floor delivers four good bedrooms, 'Master' with robes and refitted ensuite, and separate, impressive refitted family bathroom. The enclosed side garden is south facing, with large deck, lawn and artificial lawn seating area. Ingleby Homes recommended.

GROUND FLOOR

1ST FLOOR

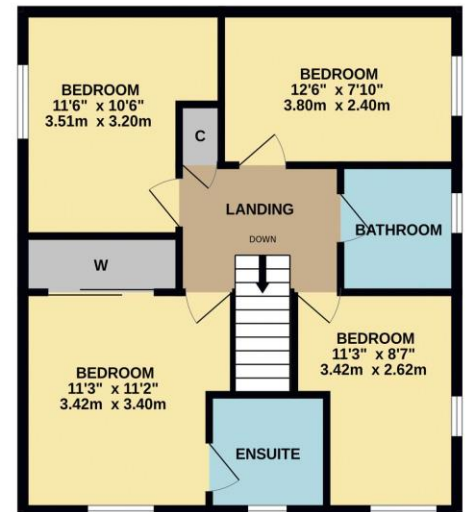

Whilst every attempt has been made to ensure the accuracy of the floorplan contained here, measurements of doors, windows, rooms and any other items are approximate and no responsibility is taken for any error, omission or mis-statement. This plan is for illustrative purposes only and should be used as such by any prospective purchaser. The services, systems and appliances shown have not been tested and no guarantee as to their operability or efficiency can be given.
Made with Metropix ©2023

“The Ingleby Barwick Experts”





Tenure: Freehold

Council Tax Band: E

EPC Rating: TBC



AGENTS NOTE: Every care has been taken with the preparation of these details, but they are for general guidance only. Measurements and dimensions are approximate, and any fixtures or fittings shown in photography does not infer that they are to be included within the sale. The agent has not tested any appliances or supplies and professional verification of these should be sought prior to purchase if required. These particulars do not constitute a contract or part of a contract.