



RESIDENCE

5 Townhead Court, Strathaven, ML10 6AU

www.residencestateagents.co.uk



Viewing by appointment with Residence Strathaven

T: 01357 572222 | E: strathaven@residencestateagents.co.uk | A: 3 Bridge Street, Strathaven, ML10 6AN



2 Bedrooms | 1 Public Rooms | 1 Bathrooms

This beautifully presented and sure to be popular, ground floor flat is set within a desirable development and located only a stones throw away from all local amenities within the town's Common Green.

The development can be entered by way of a gated entrance into communal resident's gardens or by way of the car park off the Common Green where there is residents parking with bollards.

Internally the home has been finished to a wonderful standard and offers spacious accommodation that comprises of; reception hallway, spacious lounge with aspects overlooking the residents gardens, modern fitted breakfasting kitchen that has a range of base and wall mounted storage units with worktop surfaces. The flat has two well proportioned bedrooms both with built in wardrobes and an internal three piece suite bathroom.

Features of the flat include gas central heating, double glazing, courtyard and communal gardens with resident parking bays.

Strathaven is a market Town located south of East Kilbride and Hamilton. The area offers excellent shopping facilities and sports facilities including swimming baths, bowling clubs, golf courses, public parks and country walks. Strathaven has a typical village community, a wide variety of shops within the town centre including restaurants, pubs, cafes and a large Sainsbury's. The area is highly regarded for its school catchment. For those commuting, there are excellent road links to the surrounding towns which include East Kilbride and Hamilton.



656.00 sq ft | EER = C



RESIDENCE



Townhead Court

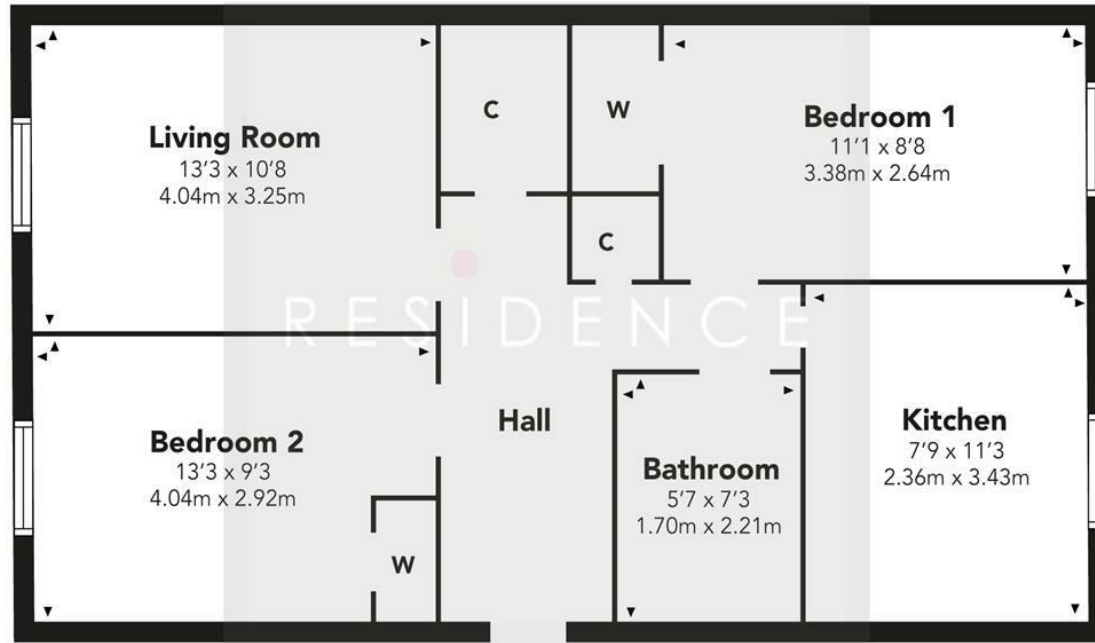

Floor Plan measurements are approximate and are for illustrative purposes only. While we do not doubt the floor plans accuracy, we make no guarantee, warranty or representation as to the accuracy and completeness of the floor plan. You or your advisors should conduct a careful, independent investigation of the property to determine to your satisfaction as to the suitability of the property for your space requirements.

Produced by Plush Plans Ltd

We believe these details to be accurate; however, they do not form any part of a contract. Fixtures and fittings are not included unless specified in the enclosed. Photographs are for general information and it must not be inferred that any item is included for sale with the property. All distances and measurements are approximate. Floorplans may not be to scale and are for illustration purposes only.