



RESIDENCE

8 Nicholswell Place, , ML10 6YR

www.residencestateagents.co.uk

Viewing by appointment with Residence Strathaven
T: 01357 572222 | E: strathaven@residenceestateagents.co.uk | A: 3 Bridge Street, Strathaven, ML10 6AN



We believe these details to be accurate; however, they do not form any part of a contract. Fixtures and fittings are not included unless specified in the enclosed. Photographs are for general information and it must not be inferred that any item is included for sale with the property. All distances and measurements are approximate. Floorplans may not be to scale and are for illustration purposes only.

3 Bedrooms | 2 Public Rooms | 2 Bathrooms

1033.00 sq ft | EER = C

Located within this recently completed and popular Borland Walk development by Lovell homes, this well presented three bedroomed semi-detached villa is an ideal starter family home.

This impressive home is sure to appeal to a wide range of buyers and offers a well-designed and spacious layout of apartments and has been finished in fresh, neutral colours and tones throughout.

The accommodation comprises; welcoming reception hallway with staircase to the upper floor level and access to a cloaks/wc with 2-piece suite. Formal lounge with aspects to front and open plan access to the bright and airy modern fitted dining size kitchen with double glazed French doors leading to the rear gardens. On the upper floor there are three bedrooms with master en-suite shower room and separate, modern fitted family bathroom.

Features of the property include gas fired central heating, double glazing and monobloc driveway. Further features include well maintained gardens with artificial grass, gravelled seating area and retractable metal frame awning.

Glassford is a small rural village on the outskirts of Strathaven. Glassford has a primary school and boasts a popular restaurant and village pub. The market town of Strathaven is nearby and offers a wide range of retail and leisure facilities with the highly regarded Strathaven Academy for Secondary education.

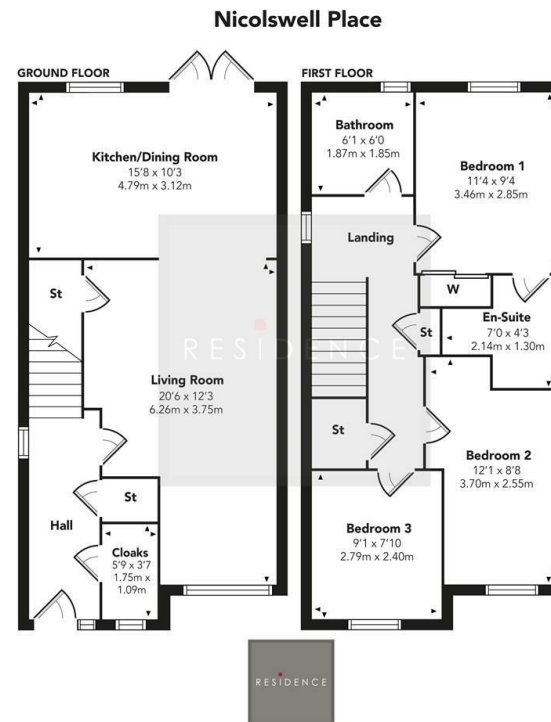

Floor Plan measurements are approximate and are for illustrative purposes only. While we do not doubt the floor plans accuracy, we make no guarantee, warranty or representation as to the accuracy and completeness of the floor plan. You or your advisors should conduct a careful, independent investigation of the property to determine to your satisfaction as to the suitability of the property for your space requirements.

Produced by Plush Plans Ltd



RESIDENCE

