

New Build Opportunities



centralpark
BRIDGEND

Western Avenue, Bridgend Industrial Estate
Bridgend CF31 3TY

FOR SALE/TO LET

- Serviced plots available for sale
- Bespoke design & build opportunities
- Buildings from 15,000 sq ft - 100,000 sq ft
- Close to Junction 35, M4 motorway
- Tier 1 grant location

Warehouse / Trade counter / Offices / Motor Dealership



Central Park is located in a prominent position on Bridgend Industrial Estate, close to Junction 35 of the M4 motorway. The development provides a strategic location which has attracted occupiers including:



Design and build opportunities are available for sale or to let for B1/B2/B8 uses. High quality accommodation with a specification to suit exact requirements can be provided.

Robert Hitchins Limited is a substantial private company that has been active in South Wales for many years, developing numerous buildings for office, industrial and retail use.

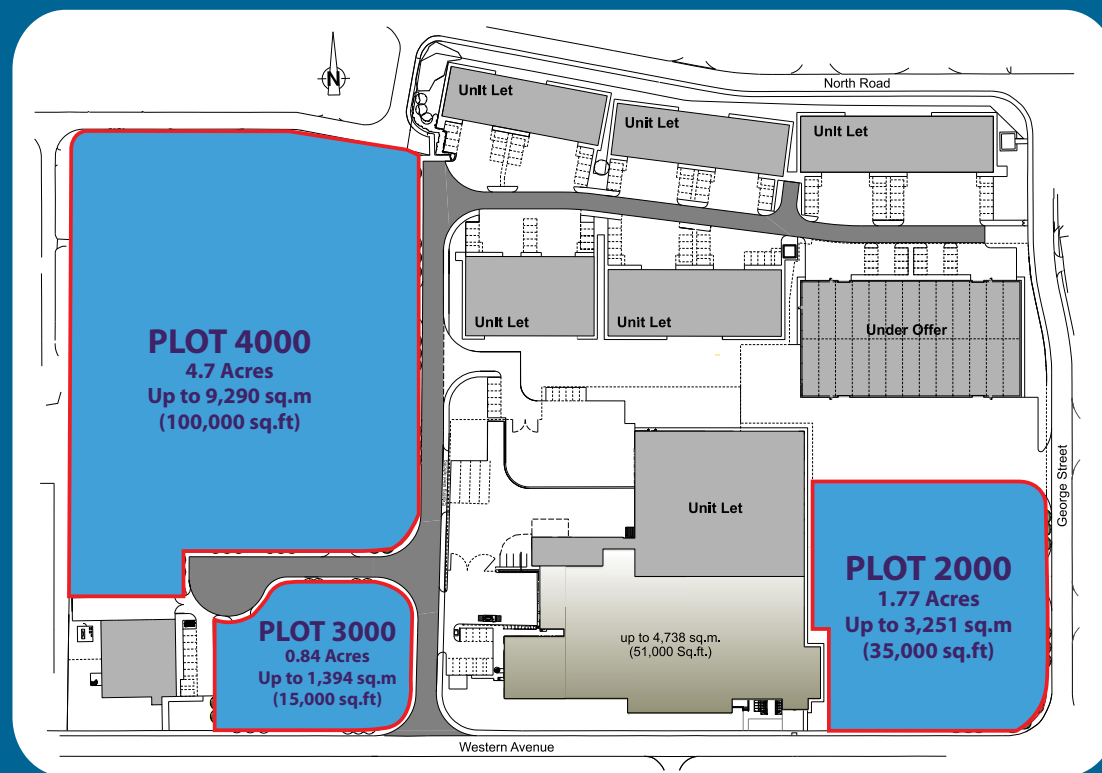

Viewing by appointment with joint agents:



neil.francis@knightfrank.com



ogriffiths@lsh.co.uk



Robert Hitchins
The Complete Development Solution

01242 680694
www.robert-hitchins.co.uk

Robert Hitchins Limited for themselves and any of their Agents give notice that; a) these particulars are prepared for the convenience of an intending purchaser or tenant and although they are believed to be correct their accuracy is not guaranteed and any error, omission or mis-description shall not annul a sale or lease or be grounds on which compensation may be claimed neither do they constitute part of a contract. All measurements are approximate. b) any intending purchaser or tenant must satisfy himself by inspection or otherwise as to the correctness of each of the statements contained in these particulars. Nothing in this information shall be deemed a statement that a property is in good condition or otherwise nor that any services or facilities are in good working order. c) all transactions are subject to contract. d) all text, photographs and plans are for guidance only and must not be relied upon as statements of fact.